

Montageanleitung.

Diese ist eine allgemeine Montageanleitung.

Montieren Sie bitte Ihre neue Wand gemäss Ihrem eigenen Planungsblatt oder Ihrer Vorschlagskizze

Stollenwandssystem. Contra Kiefer

Contra

Darüber benötigten
Werkzeuge: (Wasserschrauber)



- 4-ST1
- 4-ST1L
- 4-ST1R
- 4-ST2
- 4-ST2L
- 4-ST2R
- 4-ST3
- 4-ST3L
- 4-ST3R
- 4-ST4
- 4-ST4L
- 4-ST4R
- 4-ST5
- 4-ST5L
- 4-ST5R
- 4-ST6
- 4-ST6L
- 4-ST6R

- C60
- C61
- C3
- C4
- C5
- C6
- C8
- C18
- C20

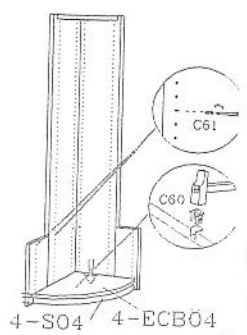
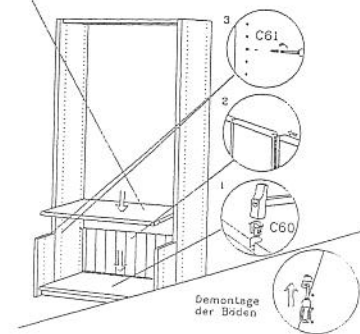
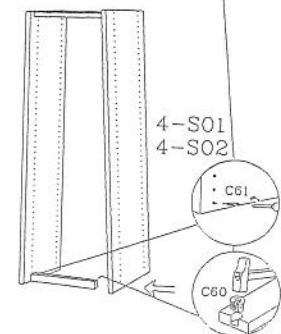
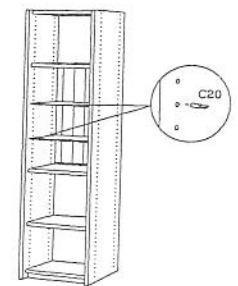
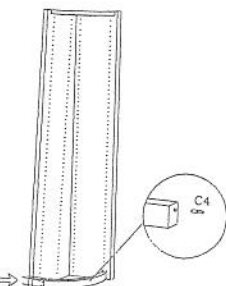
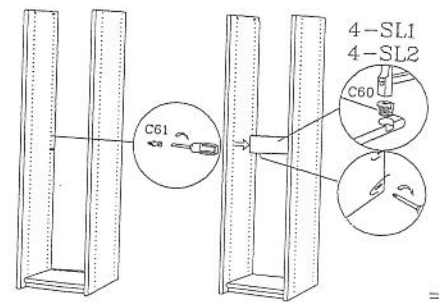
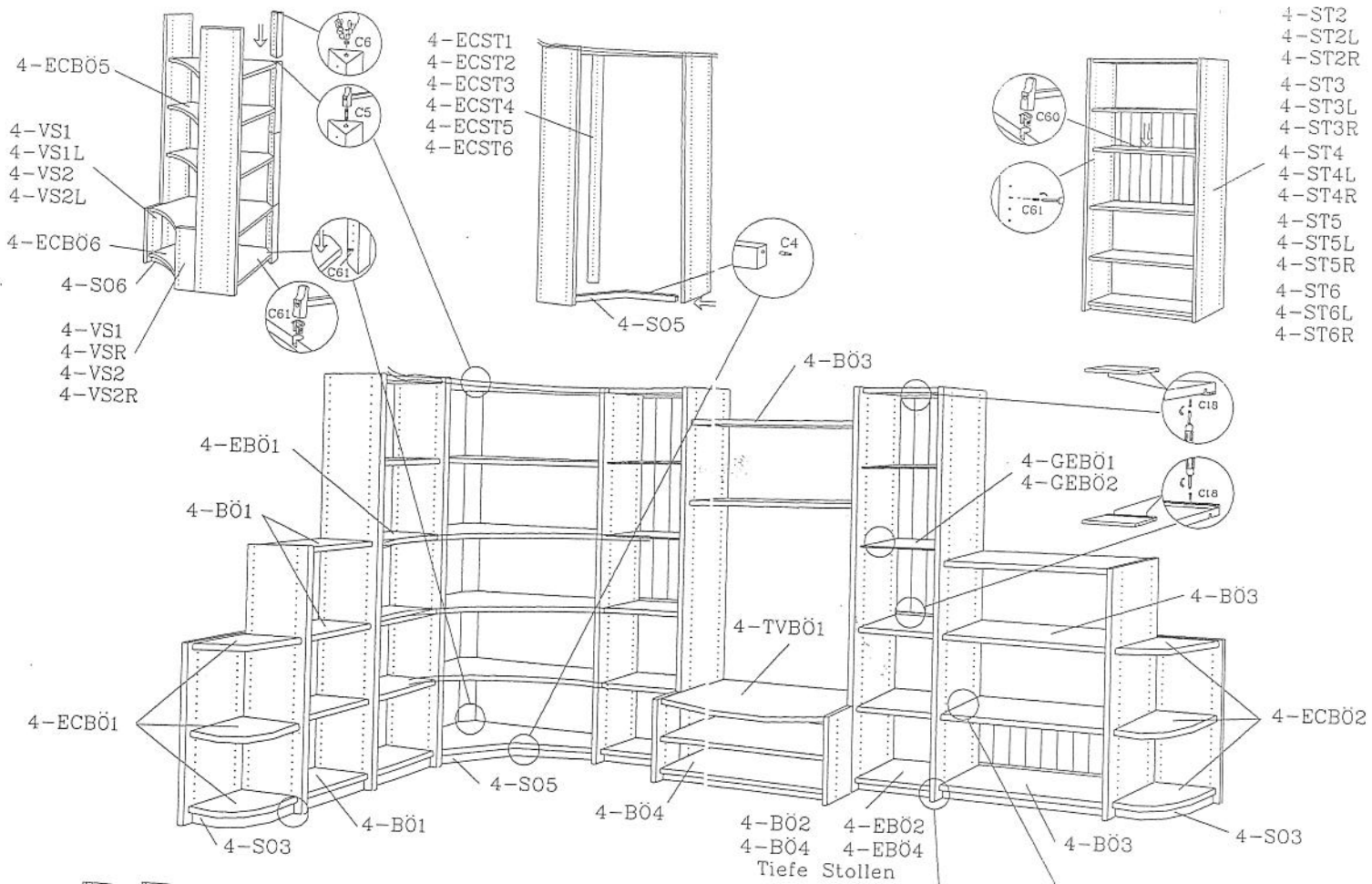

Montageanleitung.

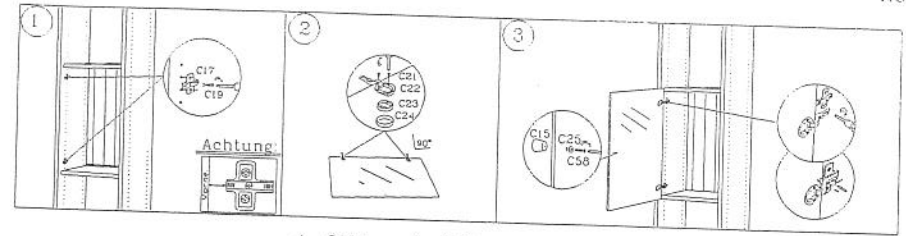
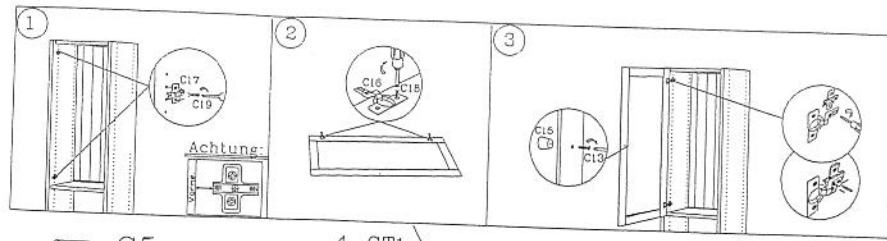

- C5
6 x 40
- C3
5,5 x 13
- C62
L
R
- C63
L
R
- C64
L
R
- C65
L
R
- C13
4,0 x 40
- C14
- C15
- C16
- C17
- C18
3,5 x 15
- C19
5,0 x 15
- C21
2,5 x 12
- C22
- C23
- C24
- C25
- C58
4,0 x 25

- 4-GT1
- 4-HT2
- 4-GT2
- 4-HT3
- 4-GT3

- 4-GV1
- 4-GV2
- 4-GV3
- 4-CS1
- 4-CS2
- 4-CS3

