

Product Parameter

Indoor use only

Wi-Fi: 2.4Ghz (802.11b/n/g)

RS485 interface(Optional)

Power Input:

Micro USB DC 5V/1A

Radio frequency: 433.91MHz, 433.92MHz

Working temperature: 0°C ~ 40 °C

Dimension(mm): L132.2 * W75 * H36



Caution

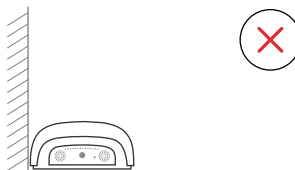

1. Stay clear of concrete walls or corners

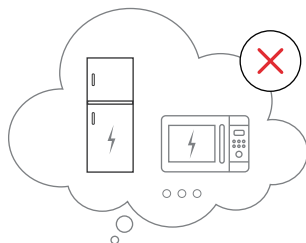

2. Keep away from electric appliances

Quick Start Guide for Connector Bridge



CAN ICES-3 (B)/NMB-3(B) of ICES-003



Product
Certification

Connector Bridge allows user to link their motorized shutters, blinds, and curtains into Wi-Fi network, enabling control via smart APP and interaction with other IoT products.

Step 1 Download APP

Please scan below QR code.



Step 2

Please scan below QR code to learn more about link up Connector Bridge with home Wi-Fi router, setup Connector APP, and establish connection with other IoT applications.

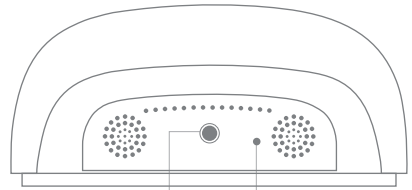

Program Button Reset

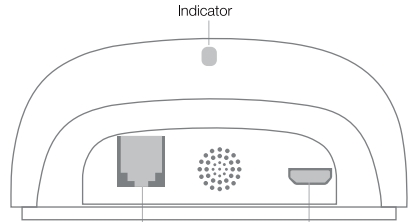

Indicator RS485 Interface Power (5V/1A)

Status Indicator

Color	Meaning	Duration
— Constant Blue	Working fine	Constant
- - - Slow Flashing Red	Wi-Fi is disconnected	Continuously till status change
- - - Slow Flashing Yellow	Wi-Fi is connected	Continuously till status change
•••• Quick Flashing Red	Bridge reset	5 times
- - - Slow Flashing Purple	Pairing underway	Continuously till status change
- - - Slow Flashing Green	Upgrade in progress	Continuously till status change

FCC Statements:

This equipment has been tested and found to comply with the limits for a Class B digital device, pursuant to Part 15 of the FCC Rules. These limits are designed to provide reasonable protection against harmful interference in a residential installation.

This equipment generates, uses and can radiate radio frequency energy. However, there is no guarantee that interference will not occur in a particular installation. If this equipment does cause harmful interference to radio or reception, which can be determined by turning the equipment off and on, the user is encouraged to try to correct the interference by one or more of the following measures:

- Reorient or relocate the receiving antenna.
- Increase the separation between the equipment and receiver.
- Connect the equipment into an outlet on a circuit different from that to which the receiver is connected.
- Consult the dealer or an experienced technician for help.

This device complies with part 15 of the FCC Rules. Operation is subject to the following two conditions:

- 1) This device may not cause harmful interference, and
- 2) This device must accept any interference received, including interference that may cause undesired operation.

MODIFICATION: Any changes or modifications not expressly approved by the grantee of this device could void the user's authority to operate the device.

This equipment should be installed and operated with minimum distance 20cm between the radiator and your body.

IC Statements:

-English:

This device complies with Industry Canada RSS standard(s). Operation is subject to the following two conditions: (1) this device may not cause interference, and (2) this device must accept any interference, including interference that may cause undesired operation of the device.

2. Changes or modifications not expressly approved by the party responsible for compliance could void the user's authority to operate the equipment.

-French:

Le présent appareil est conforme aux CNR d'Industrie Canada applicable aux appareils radio

Exempt de licence. L'exploitation est autorisée aux deux conditions suivantes :

(1) l'appareil ne doit pas produire de brouillage, et (2) l'utilisateur de l'appareil doit accepter tout brouillage radioélectrique subi, même si le brouillage est susceptible d'en compromettre le fonctionnement."

Cet équipement doit être installé et utilisé avec une distance minimale de 20cm entre le radiateur et votre corps.