

Setup & quick start for linovum smart lighting with Tuya

With the purchase of an linovum smart light source, the colourful world of lighting is open to you. To be able to use all functions, a few steps are necessary in advance.

On this page, you will find out everything you need to know about setting up and operating the lights and how to connect them to a voice assistant* such as „Amazon Alexa“ or „Google Home“.

We hope you enjoy your smart lighting!

! Before you get started, here is an important note:

Please ensure that your WLAN is set to 2.4 GHz.

Operation with Tuya is not possible in 5.0 GHz mode.

You can check this in the settings of your internet router under the item „Wi-Fi“.

Information on the use of the smart lighting outdoors:

If you want to combine our smart light source with an outdoor light, we recommend that you first configure the light source on the router. Then you can try it out in the garden to see how far the Wi-Fi connection is stable.

Please note that the range of your Wi-Fi connection is crucial for the functionality of the smart light outdoors.

Our linovum smart light sources complies with directive 2014/53/EU.

You can download the complete text of the EU declaration of conformity as a PDF document on the following page: <https://www.linovum.de/doc>

* You do not necessarily need a voice assistant to operate the light sources. You can also control the lights directly with your smartphone and the „Smart Life“ app. However, operation by voice control increases the convenience considerably, as you do not have to pick up your smartphone every time.

1. Installing the Smart Life App

The first thing you need is the Smart Life app, regardless of whether you want to control your smart lights directly or via voice assistant. The app serves as an interface between your lights and the configuration.

1.1 Download the Smart Life App

Visit the Google Play Store or App Store with your smartphone. The Smart Life App is available for Android & iOS.

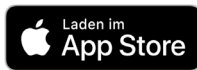

1.2 Register with Smart Life

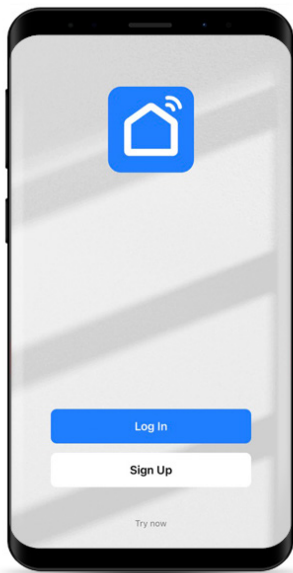

After installing the Smart Life App: Click on „Sign Up“ at the beginning.

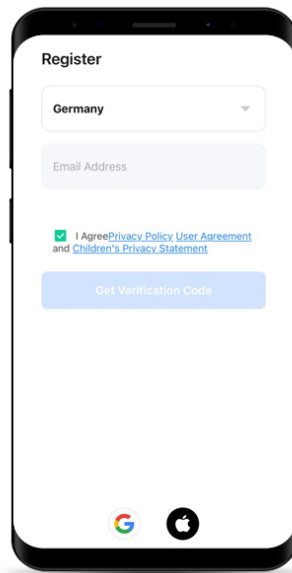

Now enter your e-mail address and confirm it with „Get Verification Code“. This step is for your own security.

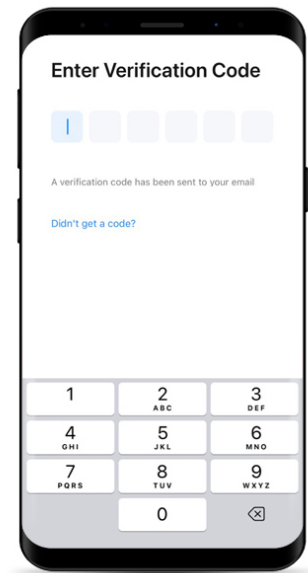

Now wait until you receive your code by e-mail and enter it in the app.

In the next step you will be asked to choose your personal password. Please note that the password should be as secure as possible (upper & lower case letters, numbers and special characters).

! Important notice for the next step 1.3:

When installing several lights, we recommend that you couple only 3 lights at a time. Otherwise, the commissioning may not work smoothly. However, a total of more than 3 lights can be installed per circuit. Only the setup up should be done one after the other (3 lights each).

1.3 Add light sources & lamps in the app

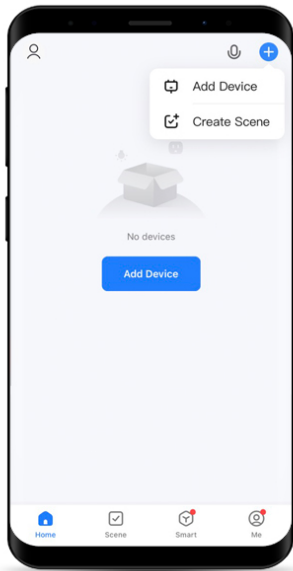

After registration, you will see the following screen - click on the plus symbol at the top right and choose „Add Device“.



Now select „Lighting“ in the left-hand menu and then „Light Source (Wi-Fi)“.

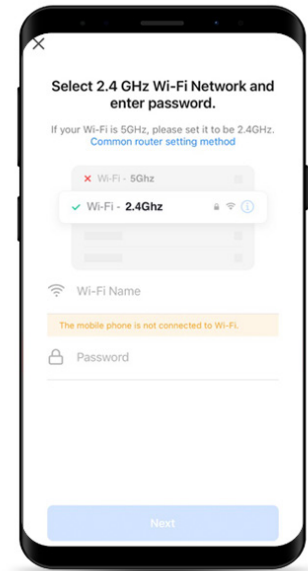

Select your Wi-Fi Network and enter the corresponding Wi-Fi password. Make sure that your Wi-Fi is set to 2.4 GHz!

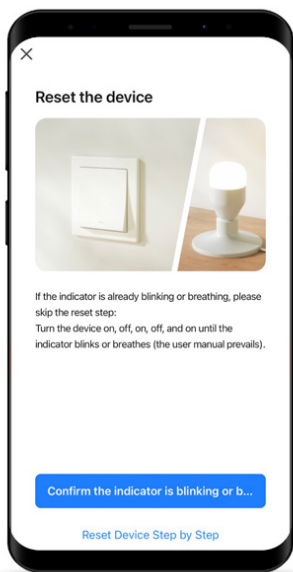

First switch on the purchased light with the smart light source. If the light flashes directly (your light at home, not in the app), select „Confirm the indicator is blinking“ Otherwise, select „Reset Device Step by Step“ and follow the described steps.

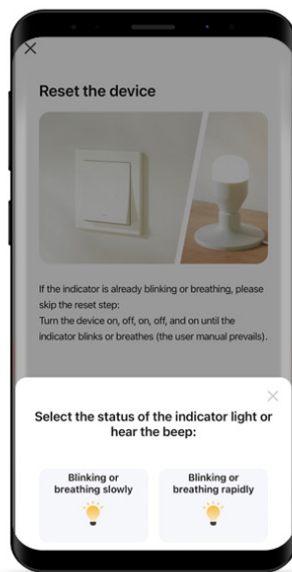

After confirming, that the light is blinking, select the status of the light.

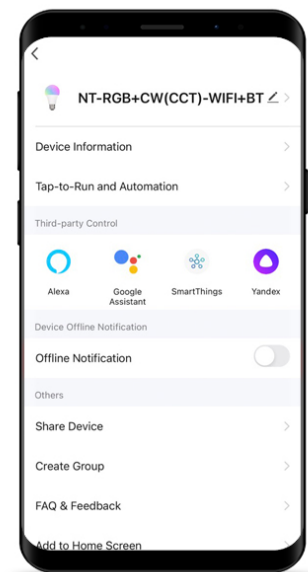

Wait until the light is found and added. Once your light has been found, we recommend giving it a meaningful name (from [model name] to e.g. Smart Light GU10). Click on the pencil in the upper right corner to change the name.

1.4 Control lights with the Smart Life app

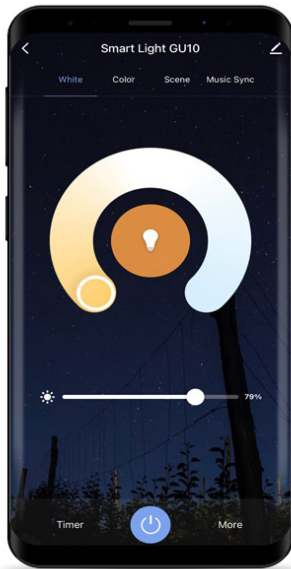

After you have clicked on your light or group (will be explained later), you can use the rotary controls to adjust the colour temperature or dim the light.

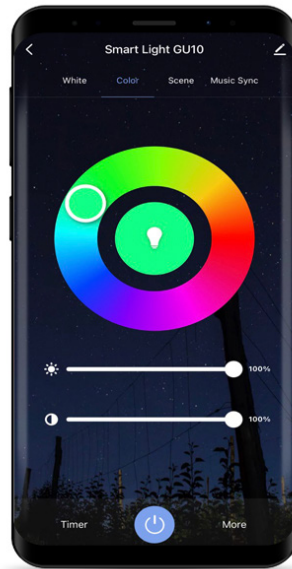

Click on „Colour“ at the top of the menu to set the colour of the light. In addition, you can also dim or adjust the colour intensity here.



Scenes are ready-made programmes that automatically change the light or the light colour, for example – just try it out!

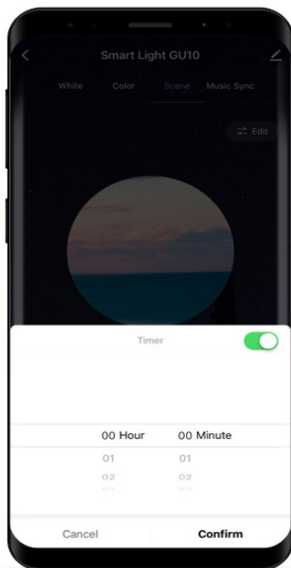

At the bottom left you will find the timer. Here you can set when the light switches on or off automatically, just like on a TV.

1.5 Create light groups

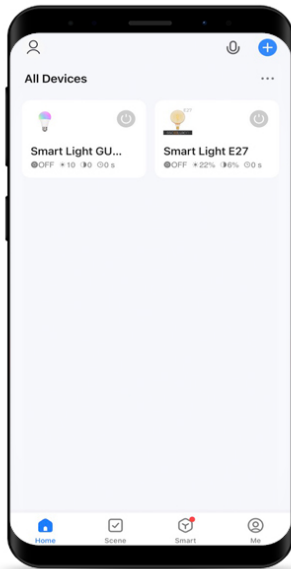

Go to the overview, where you can see all devices and click on the name of one of the lights you want to add to a group.



Click on the pencil at the top right.

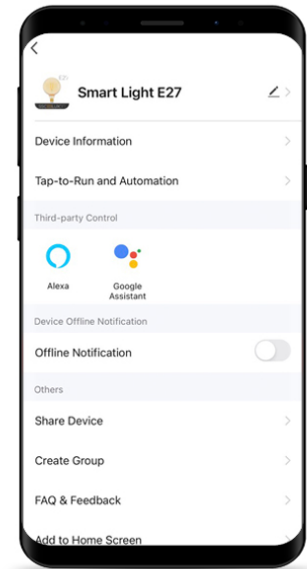

Choose „Create group“.

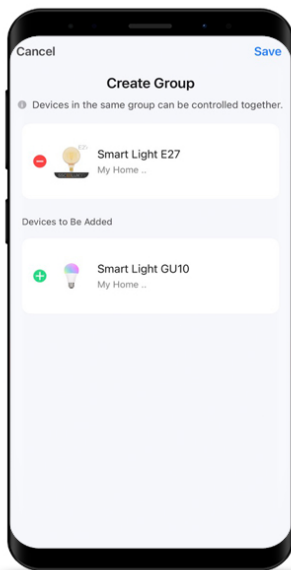

Now select all the lights you want to assign to the group and click save at the top.

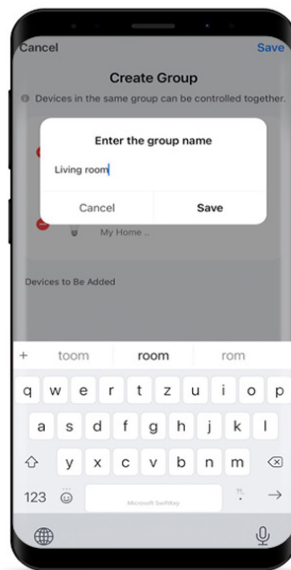

You will now be asked to give the group a name (e.g. Living room).

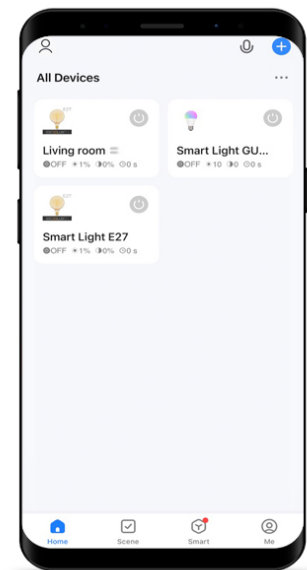

Done – now you can control all lights within a group in the same way as individual lights (described in step 1.4).

2. Control with Amazon Echo (Alexa)

2.1 Connection with Amazon Echo

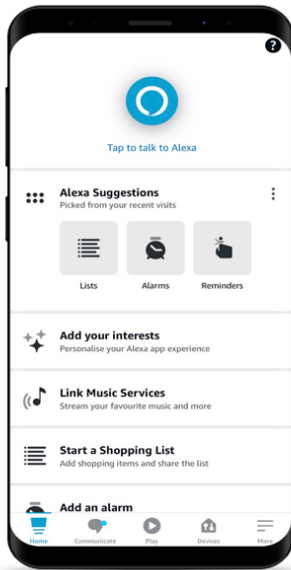

After setting up the Smart Life App, start your Amazon Alexa App. Click on „More“ in the menu.

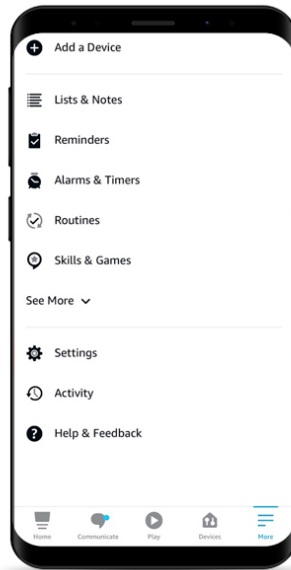

Select „Skills & Games“ on the left side.

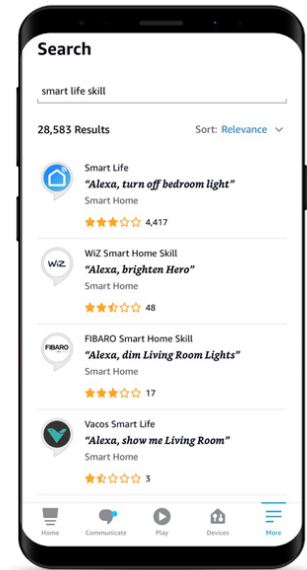

Use the search function to find the „Smart Life“ skill. Then click on it.

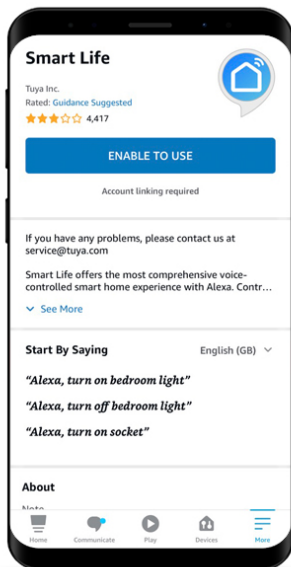

Press the „Enable To Use“ button to activate the skill.

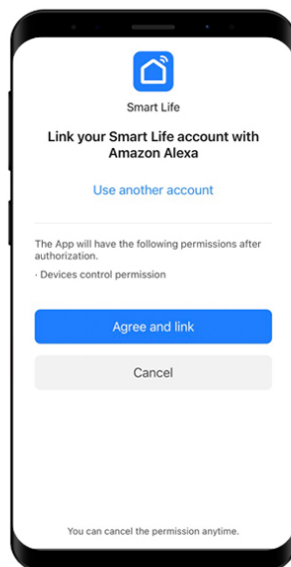

In the last step, you must agree the connection by clicking „Agree and link“.

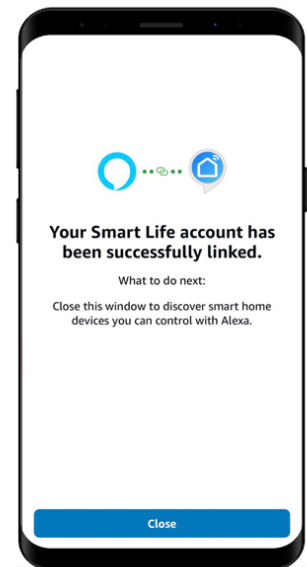

The Amazon Echo Smart Life Skill has been linked successfully. In the next step, add your lights.

2.2 Add lights to Amazon Echo

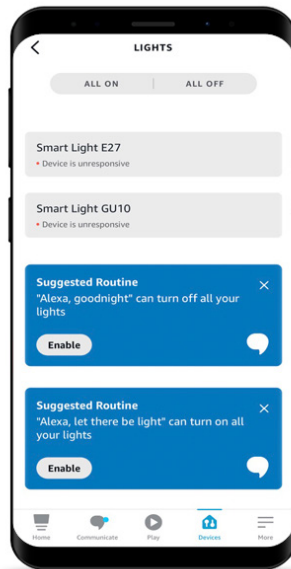
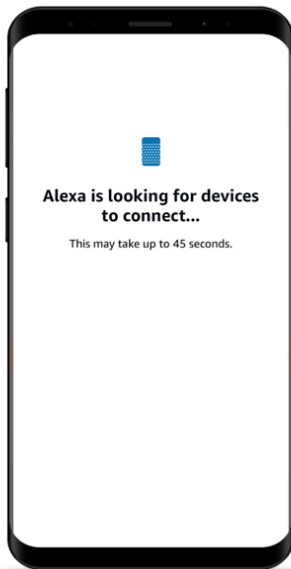

Now add the lights you have set up in the Smart Life App to your Echo. To do this, press „Detect Devices“. Searching for new devices can take up to 45 seconds. Wait and do not switch off the smartphone.

You will then see the lights in the overview. These have the same names that you previously assigned in the Smart Life App.

2.3 Create groups in Amazon Echo

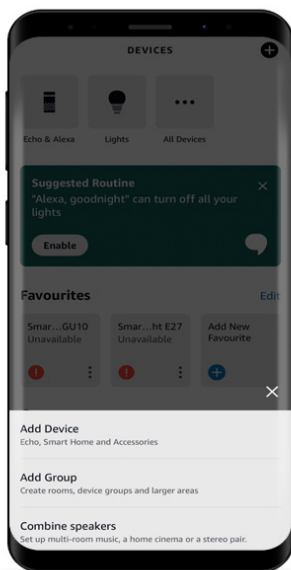

Click on „Devices“ in the main menu, then on the plus at the top right and select „Add Group“.

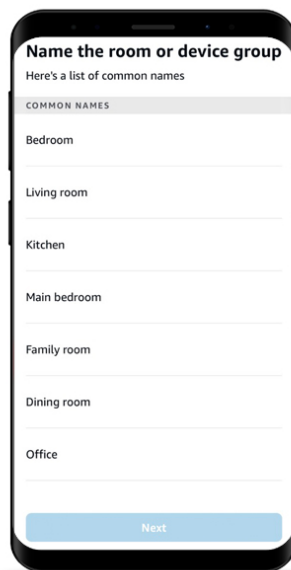

You will see an overview, how to set up a group. Click „Next“. Give the group a name, e.g. Living room.

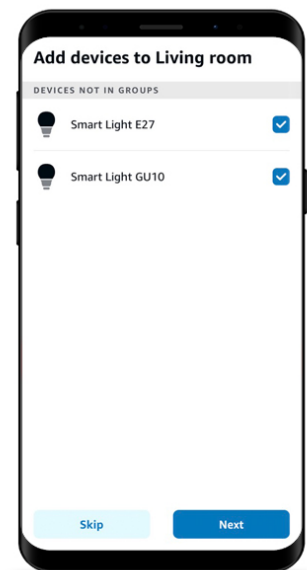

Select the lights to be grouped.

2.4 Voice commands to control lights with Amazon Echo

Overview of the most important commands for controlling your smart lighting with Amazon Echo:

„Alexa, turn [device name or group name] lights on.“

Example: Alexa, turn living room lights on..

„Alexa, turn [device name or group name] lights off.“

Example: Alexa, turn living room lights off.

„Alexa, [device name or group name] lights on.“

Example: Alexa, living room lights on.

„Alexa, [device name or group name] lights off.“

Example: Alexa, living room lights off.

„Alexa, brighten the lights [device name or group name] to 50 %.“

Example: Alexa, brighten the lights living room to 50 %.

„Alexa, make my lights [device name or group name] warmer.“

Example: Alexa, make my lights [device name or group name] warmer.

„Alexa, [device name or group name] lights red.“

Example: Alexa, living room lights red.

3. Control with Google Home

3.1 Connection with Google Home

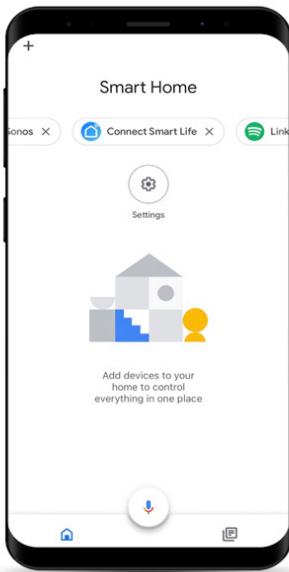

After setting up the Smart Life App, start your Google Home App. Search the button „Connect Smart Life“ in the upper horizontal menu and click on it.

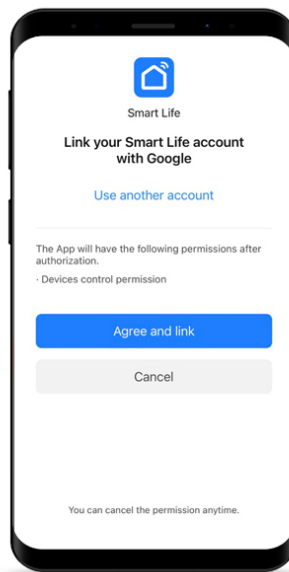

Agree the connection by clicking „Agree and link“.

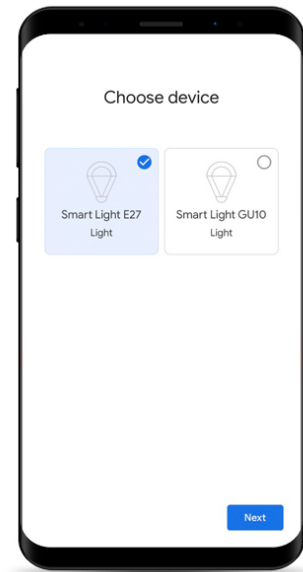

Choose the devices, you want to connect.

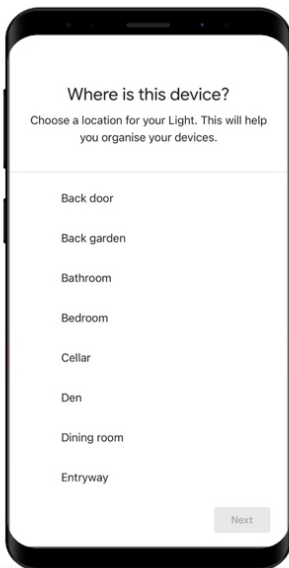

Now select a room that you want to assign to the light. In our example, „living room“.

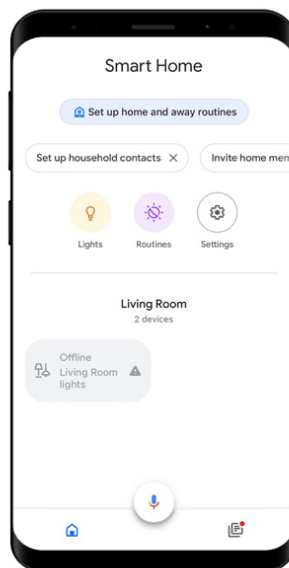

The added devices are now visible in the home screen of the Google Home app.

3.2 Control lights with Google Home

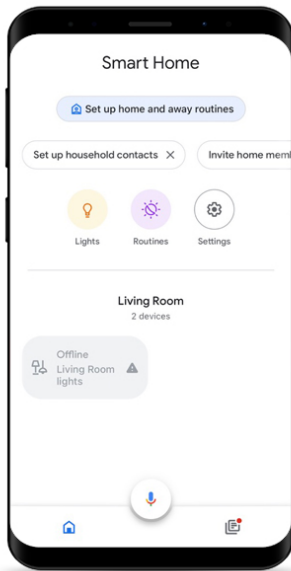

You can now control the light via the app (voice commands follow below).
Click on the light or room to enter the control center.

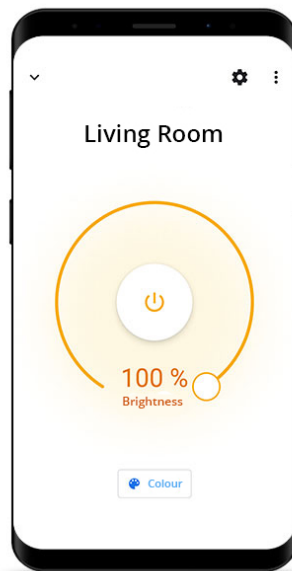

Here, the rotary control can be used to dim the brightness, switch the light on/off and adjust the light colour.

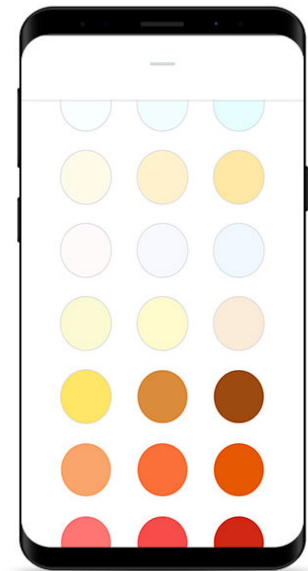

After clicking on the „Colour“ button, you can choose from one of the numerous colour modes.

3.3 Manage lights in rooms & groups with Google Home

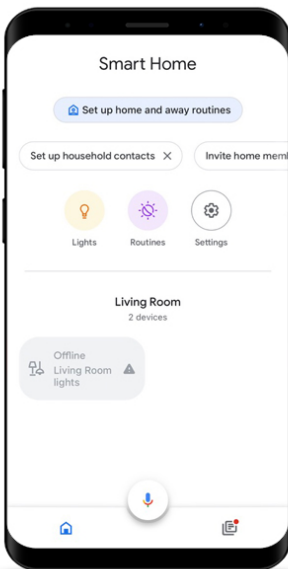

Click on settings on the home screen to edit a group.

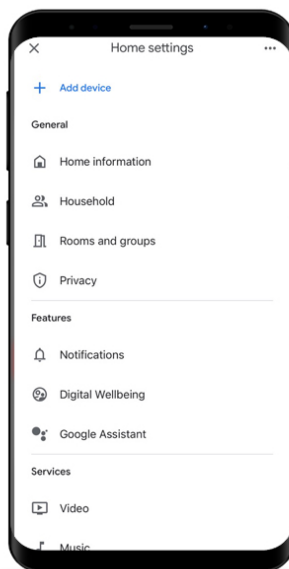

Choose the item „Rooms and groups“ and select the room you want to manage.

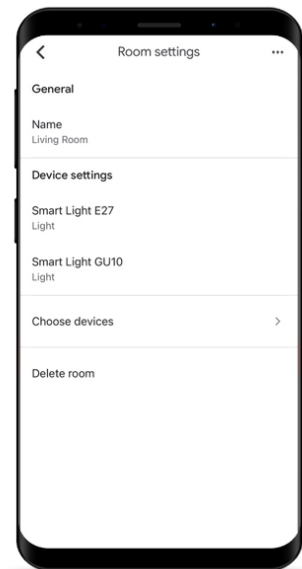

Here you can change the name of the room, add devices or delete the room.

3.4 Voice commands to control lights with Google Home

Overview of the most important commands for controlling your smart lighting with Google Home:

„Ok Google, turn [device or group name] on.“

Example: Ok Google, turn living room on.

„Ok Google, turn [device or group name] off.“

Example: Ok Google, turn living room off.

„Ok Google, [device or group name] on.“

Example: Ok Google, living room on.

„Ok Google, [device or group name] off.“

Example: Ok Google, living room off.

„Ok Google, set [device or group name] to 50 %.“

Example: Ok Google, set living room to 50 %.

„Ok Google, turn [device or group name] red.“

Example: Ok Google, turn living room red.