

Stem  $\phi 9.89\text{mm}$  according to SAE J2044  
Embout  $\phi 9.89\text{mm}$  suivant SAE J2044

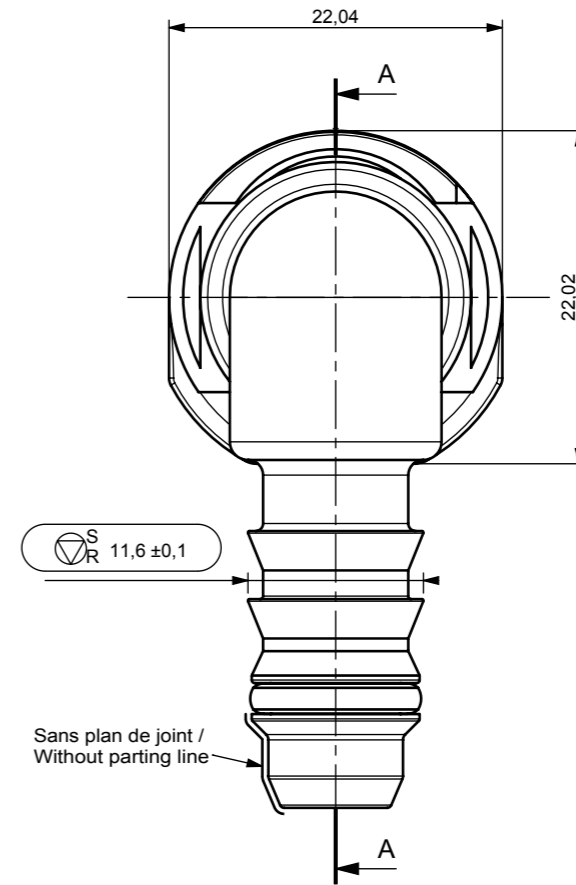

VUE ISO / ISO VIEW  
Ech/Scale: 1/1

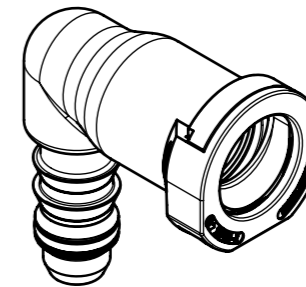

8	1	Graisse/Grease	ASTM D217
7	1	Joint Torique/O Ring	Fluorocarbone/Fluorocarbon
6	1	Bague/Retainer	PA12 GF30
5	1	Douille/Sleeve	PA12 GF30
4	1	Joint torique/O'ring	Fluorosilicone/Fluorosilicon
3	1	Rondelle/Washer	Laiton/Brass
2	1	Joint torique/O'ring	Fluorocarbone/Fluorocarbon
1	1	Corps/Body	PA12 GF30 noir/black
N°	Nb	Désignation/Part Name	Matière/Material

08	Blanc/White
07	Orange
06	Gris/Grey
05	Jaune/Yellow
04	Bleu/Blue
03	Rouge/Red
02	vert/Green
01	Noir/Black
00	Naturel/Natural
Code YY YY Code	Couleur/Color

Echelle  
Scale:  
2:1  
**A3**  
Traitement:  
Treatment:  
Matière: voir tableau  
Material: refer to table

Unit: mm

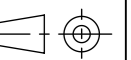

Plan Approuvé par/Approved by: MCI

Date: 03/02/2017

Volume : 7389.94 mm3

Tolérances générales/General tolerances

Ra - Ang:  $\pm 2^\circ$  Dia:  $\pm 0.5$

Rad: - Leng:  $\pm 0.5$



NORMA Autoline France SAS  
24, rue Blaise Pascal BP 48002  
F-35580 GUICHEN

Créé par:  
Created by:  
ATY

Date:  
09/04/1999

Désignation/Title  
RE équerre  $\phi 9.89$ , Bague standard, 2 joints, queue 2 dents avec joint pour tube  $\phi 8\text{int}$ .  
Elbow QC  $\phi 9.89$ , Standard retainer, 2 o'ring, 2 barbed on tail with o'ring for ID8 tube.

Référence plan  
Drawing number

**A624-52-08-YY**

Révision / 08  
Doc Sheet 1