



KAHE
E-NAUTIC SOLUTION



INSTRUCTIONS

KAHE POD 600



HELLO !

You have just acquired a Kahe POD 600, the most modular and innovative electric propulsion system of its generation for watercraft. It will enable you to power your light watercraft with power, silence, without odor, and without carbon emissions in aquatic environments.

Its unprecedented modularity will also allow you to use it with a single click for underwater scooter rides or as electric assistance for certain water sports.

Finally, its state-of-the-art electronic functions will introduce you to countless possibilities: wireless control, mobile application, multi-engine mode usage, advanced safety features, and more.

BEFORE GOING INTO THE WATER ----	3
REMOTE CONTROL ----	8
APPLICATION ----	15
USAGE ----	24
MAINTENANCE ----	34
SPECS ----	39



BEFORE GOING INTO THE WATER

SAFETY ----	4
PRODUCT REGISTRATION ----	6
APPLICATION DOWNLOAD ----	7

SAFETY

Your Kahe POD is equipped with a propeller that spins at high speed. Special attention is required to avoid any injury during the use of your equipment.



The safety features we have integrated

The propeller is fully enclosed to provide maximum protection.

An additional protective grid, protecting both the upstream and downstream sides of the propeller, is available as an option. It provides maximum safety in all cases where you are operating close to the motor (for example, in underwater scooter mode; the grid is included by default with the snorkeling handle).

The propeller stops within a few seconds if it is out of the water. The propeller can only start once the remote control is turned on and after pressing the power button.

Safety first !

Respect local navigation rules.

Never put your fingers (or any other part of your body !) or objects into the propulsion.

If you have long hair, tie it back to prevent it from getting caught in the propeller in case of a fall.

Always turn off the remote control (to prevent accidental start-up of the propeller) before any intervention on the propulsion, such as cleaning algae caught in the grid, for example.

The remote control must always remain with you when using the Kahe POD 600 on a boat; it serves as an emergency stop (if you fall into the water with the remote control, the Kahe POD 600 will automatically stop within a few seconds). Otherwise, use a safety beacon allowing you to leave the remote control on the tiller, for example.

When stand-up paddleboarding or kayaking, always use a paddle: you should always be able to return to shore without the use of the electric motor.

CHILDREN

The Kahe POD 600 is not recommended for children under the age of 16. Regardless of the child's age, adult supervision is mandatory for any use. You must ensure that the watercraft and electric motor are in perfect working condition and that the child understands how to use the Kahe POD safely, as described in this user manual.



REGISTRATION AND WARRANTY FOR YOUR KAHE POD

It is important that you register your product so that we can provide you with the best available services. This way, you will be kept informed of the latest updates, our advice, and any other information to facilitate your practice safely. Do not open the product (front nose cone) under penalty of warranty cancellation.



KAHE products are covered by a 2-year warranty. The warranty covers manufacturing defects in the equipment and is strictly limited to the replacement of recognized defective or non-compliant parts after inspection by us.

The product or parts under warranty must be returned by the buyer to their brand distributor or to our workshops, at their own expense and risk, accompanied by an explanatory letter of the malfunction as well as the purchase invoice. This manufacturer's warranty does not affect the legal rights of consumers applicable under French law. This warranty does not cover products intended for rental or professional use.

The following are excluded from the warranty:

- Non-compliant use of the propulsion for purposes other than its intended use (marine motor for light watercraft, underwater scooter for snorkeling with a depth limit of 5 meters)
- Failure to follow usage instructions and precautions as described in this user manual
- External elements or mishandling of the equipment: falls, impacts, accidents, vandalism...
- Lack of maintenance or improper care not in accordance with the operations described in this user manual
- Repairs, interventions, or modifications performed by individuals or entities not authorized by the brand
- Normal wear and tear of various product components: propeller, bearings, sacrificial anode (washer in front of the propeller fixing nut), decreased battery performance over time, wear parts...

APPLICATION DOWNLOAD

Before using your Kahe POD for the first time, it is recommended to download the KAHE application to access all possible settings !

The application is available on the Google Play Store (Android) and the Apple App Store (iOS): simply search for «Kahe Nautic».

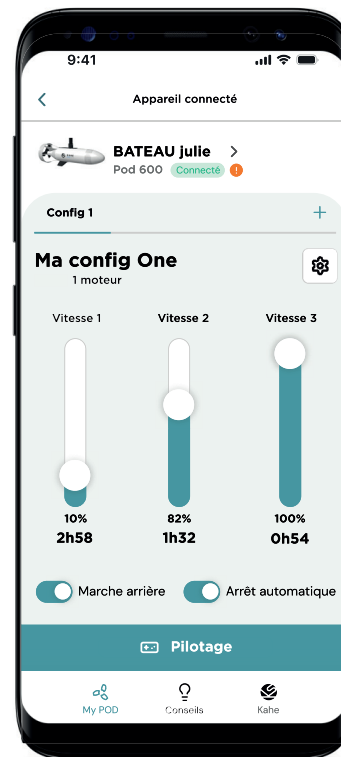

REMOTE CONTROL



ACTIVATE THE REMOTE CONTROL ---- 9

PAIR THE REMOTE CONTROL WITH THE KAHE POD ---- 10

GREEN LIGHTS: SPEEDS AND RECHARGE ---- 11

RED LIGHTS: BATTERY LEVELS ---- 12

CONFIGURATION CHANGE ---- 13

REMOTE CONTROL FIXATION ---- 14

ACTIVATE THE REMOTE CONTROL



The remote control allows you to pilot your Kahe POD. With it, whether you're on (or under) the water, you can select your speed and monitor the battery charge level.

To activate your remote control, simply press the central button for 2 seconds. Pressing the central button again for 2 seconds turns off the remote control.



REMOTE CONTROL > KAHE POD CONNECTION

The blue indicator light is off:
the remote control is connected to your Kahe POD.

The blue indicator light is blinking:
the remote control is not connected, your Kahe POD must be nearby, and the
remote control must be paired with it.

First-time use?

Pair your remote control with your Kahe POD (see next page).



PAIRING THE REMOTE CONTROL WITH THE KAHE POD

At first use, it is necessary to pair your Kahe POD with your remote control. Each remote control has a randomly chosen frequency channel to which the Kahe POD 600 must synchronize. The first engine paired with the remote control will become its primary engine.

1 - Turn on the remote control
by pressing the central button
for 2 seconds.

2 - Enter pairing mode.

Press the + and - buttons on the remote control simultaneously
until the blue indicator light flashes rapidly.

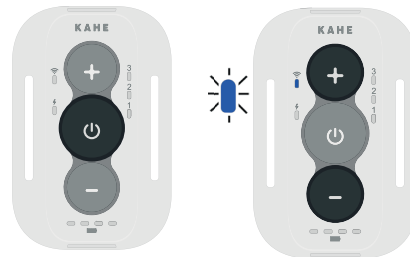

3 - Charge your Kahe Pod 600 to be paired,
this will enable pairing during the first 30 seconds of charging.
If you have multiple electric assist products, **make sure it is
the only one nearby:** the remote control should only be able to
detect the product you want to pair with.



4 - It's done !

Wait for 30 to 60 seconds for the pairing process to complete. Once completed,
the blue light will turn off. Pairing only occurs once.
Your remote control and your Kahe POD will now always remain paired.

GREEN LIGHTS: SPEEDS, REVERSE, AND CHARGING



SPEED SELECTION / REVERSE MODE

Once the remote control is activated, you can choose the speed using the + and - buttons on the remote control. The green indicator corresponds to the selected speed: speed 1, 2, or 3.

If the reverse function is activated (see «settings» in the mobile application), you must reduce the speed by pressing the - button until the motor stops, then continue pressing the - button to switch to reverse. The green indicator will then start flashing and correspond to the selected speed 1, 2, or 3, in reverse.

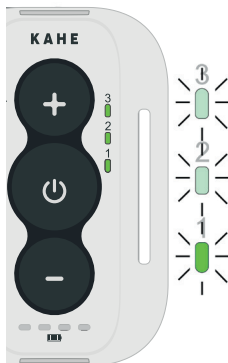

REMOTE CONTROL RECHARGING

Plug the cable provided with your remote control into a USB port (USB charger or computer port). At the other end of the cable, connect the magnetic plug to the back of your remote control. The green lights on the remote control will illuminate, indicating the charging status. When all 3 green lights remain continuously lit, the remote control is fully charged.



RED LIGHTS: BATTERY LEVELS

KAHE POD BATTERY

- 4 lights: all good, enjoy!
3 lights: 50 to 75% battery remaining
2 lights: 25 to 50% battery remaining
1 light: 10 to 25% battery remaining
It's time to head back :)
1 flashing light: less than 10% battery remaining, recharge required.



4 red LEDs	> 75%
3 red LEDs, 1 white LED	50 à 75 %
2 red LEDs, 2 white LEDs	25 à 50 %
1 red LED, 3 white LEDs	10 à 25 %
1 flashing red LED, 3 white LEDs	< 10%

To avoid damaging the battery, the Kahe POD automatically shuts off when there is less than 3% battery remaining.

REMOTE CONTROL BATTERY

The remote control has a battery life of approximately 10 hours.

The red light flashes: less than 30% battery remaining.

The red light flashes rapidly: less than 10% battery remaining, it's time to recharge your remote control :)



 < 30%

 < 10%

IMPORTANT



When the LEDs blink from left to right, it means that a beacon or a secondary motor is not detected. Beacons do not work when the app is connected to the motor: you must exit the application before going into the water !

CONFIGURATION CHANGE

The KAHE mobile application allows you to save up to 4 different configurations (see page 18). It is possible to switch between configurations using the remote control.

1 - With the remote control turned on, press all 3 buttons (+, -, and central button) simultaneously.



The blue indicator light turns on. The illuminated red indicator light indicates which configuration is being used (1 to 4). In the example above, configuration 2 is selected.

2 - Change configuration by pressing the + or - buttons.



The indicator light will change position (for example, here to configuration 3) after pressing the + button.

3 - Confirm your selection with the central button.



REMOTE CONTROL ATTACHMENT

ON TILLER OR PADDLE

Clip the small black piece onto the level that is most suitable for you, then attach the remote control around this piece using the Velcro strap.

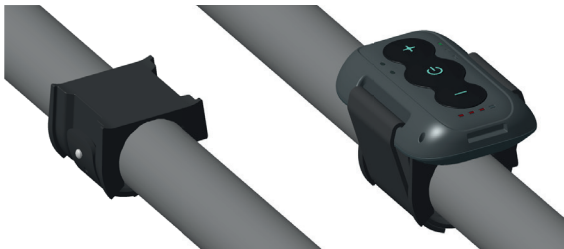

ON THE WRIST



Use the Velcro strap to secure the remote control on your wrist. Two sizes of straps are provided with your remote control to fit all wrist sizes.

ON THE SNORKELING HANDLE

Attach the remote control to the designated spot on the handle, either on the left or right side, using the shortest size of the Velcro strap.





APPLICATION

FIRST CONNECTION ----	16
MY POD MENU ----	17
CONTROL MENU ----	19
TIPS & KAHE MENUS ----	23

FIRST CONNECTION

After installation, the application guides you through your first connection. Your phone's Bluetooth and location services must be enabled. You need to turn on the remote control of your Kahe POD 600 (see page 9). The application will ask for access to some information; this is optional, but it will help us better understand how KAHE products are being used. We will not use this data for any other purpose.

The first step is to connect your Kahe POD 600 to the application. You then have access to all settings (My POD menu), important information (Tips menu), and ways to contact us (KAHE menu).



My POD



Conseils



Kahe



IMPORTANT

When the Kahe application is connected to your motor, the optional safety beacons are automatically deactivated: fall detection by beacon is no longer operational (the LEDs on the remote control blink from left to right).



MY POD MENU (1/4)



> Speed

You can configure the three speed levels as you like using the available sliders. The battery life is calculated based on the battery charge level. This may vary slightly depending on other factors (wind, current, type of vessel, etc.). While navigating, you can select your desired speed using the + and - buttons on the remote control.

> Reverse

If this function is enabled, you can switch to reverse mode by pressing the - button on the remote control until the motor stops, then holding the - button to engage reverse mode.

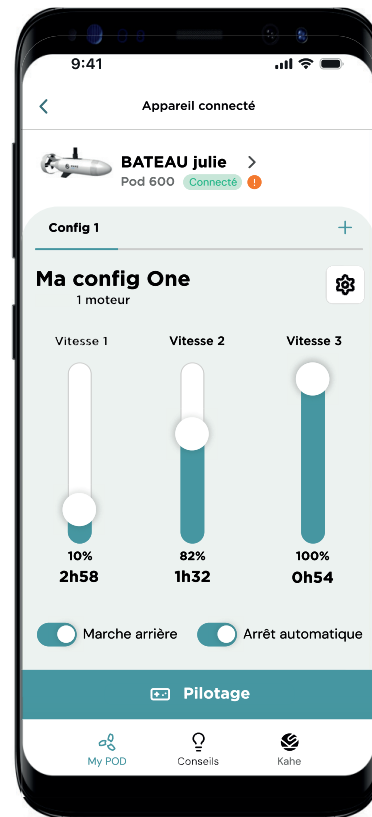

MY POD MENU (2/4)



> Kahe POD connected

The first line displays the Kahe POD currently connected to your phone via Bluetooth (or not detected but saved in memory). By clicking on it, you can access a menu (rename, info, etc.).



BATEAU julie >
Pod 600 Connecté

> Rename my Kahe POD

By clicking on the POD's name, you can rename your device as you wish. The name will be saved in memory, allowing you to recognize your Kahe POD even if other devices are nearby.

> Communication Channel

In the same menu, you can change the communication channel. When you are on the water with multiple people using electric motors with remote controls, each device must be set to a different channel to avoid interference.

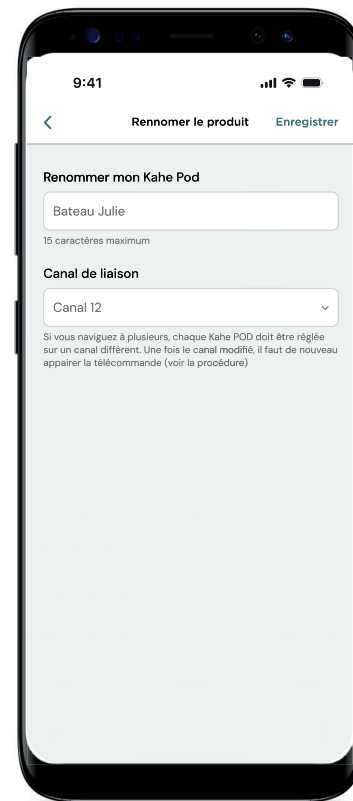

MY POD MENU (3/4)



> Total usage

Usage Duration: This is the total operating time of the motor since it was activated.

Electric Energy Consumed: This is the total energy consumed by the motor since it was activated, expressed in kilowatt-hours (kWh).

Carbon Emissions Avoided: This is an estimate of the carbon dioxide emissions avoided compared to using a combustion engine. Data used:

	2.5 hp THERMAL ENGINE	KAHE ELECTRIC ENGINE
Energy Consumption	1L/h of gasoline	600 W
CO2 equivalence	2.8 kg / L of gasoline (datas ADEME)	0.45 kg / kWh (ADEME for Europe)

> Advanced Settings

Allows you to perform software updates for your Kahe products, to enjoy the latest innovative features implemented.



MY POD MENU (4/4)



> Configurations

You can create up to four different configurations, which are saved in memory. For example, you might have one configuration for a boat with higher power and reverse mode enabled, and another for an underwater scooter with lower power and no reverse mode.

To create a new configuration, tap + in the top right corner. To switch between configurations, select the desired one. You can rename configurations by clicking the settings icon next to their name. You can also switch between configurations using only the remote control (see page 13).

> Management of Connected Devices

There are multiple options available (settings icon), allowing you to:

- Control multiple motors with a single remote control (up to four motors in parallel).
- Pair safety beacons with a remote control (up to four). A beacon is a small keychain-like device that communicates with the remote. It detects if the wearer falls into the water and automatically shuts off the motor(s) in case of a fall.
- Define the position of your motor (left, right, or center): this is only necessary for differential control when using two or more motors (in app-controlled mode).

For one or more secondary motors to be recognized, they must first be paired with the remote control that will control them as secondary motors.

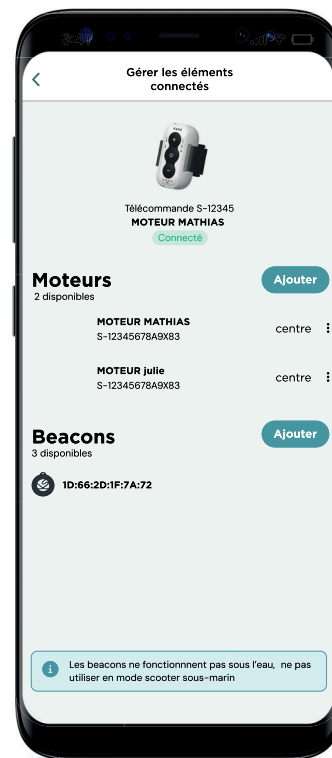

CONTROL PANEL (1/2)



Pilotage

> Battery

At the top, you have access to the charge/discharge level of your Kahe POD 600 battery (on the left) and the remote control (on the right), as a percentage of their total capacity.

> Pilot Your POD

The main button on the left allows you to turn the motor on or off. Upon the first activation, a confirmation message is requested, and the speed is set to zero to prevent any accidental startup of the propeller.

On the right, with a simple swipe of your finger, you can move the slider to increase or decrease the motor power and switch to reverse. The speed shown corresponds to your phone's speed using its integrated GPS. The range is an indication based on the charge level of your battery, and it may vary slightly due to factors such as current, wind, or type of vessel. When controlling the motor via the app, the remote control acts as a relay: it must be turned on and within range of both the motor and your phone!

> CAP

At the bottom center, the compass provides heading information (the motor's orientation relative to the Earth's magnetic north).

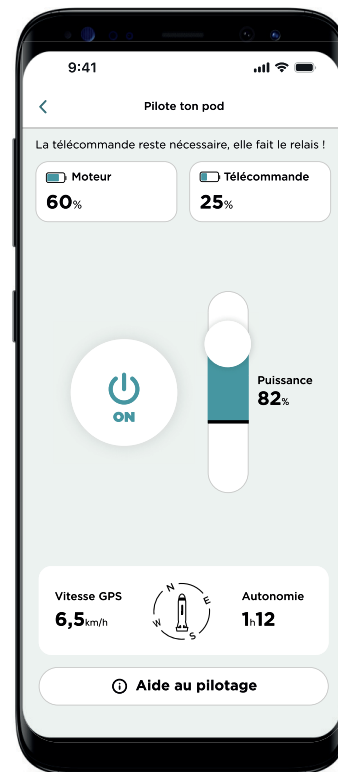

CONTROL PANEL (2/2)



Pilotage

MULTI-MOTOR CONFIGURATION

You can configure your remote control to control multiple motors at once (see page 20). If this is the case, the control menu expands with new functions and indications.

> Batteries

With multiple motors (e.g., here with 3 motors), the capacity of each battery is displayed.

> Differential

If you have configured one or more motors on the left and right sides of your watercraft, you can use the speed differential between the motors to rotate and thus steer your watercraft.



IMPORTANT

The security beacons (optional) are not operational when you pilot your POD with your mobile !

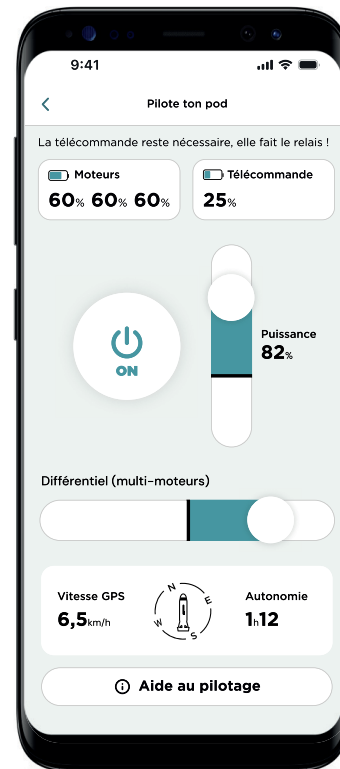

TIPS & KAHE MENU



TIPS

This page allows you to access at any time the necessary information to use your Kahe POD to the best of its ability: safety rules, maintenance, and usage instructions.



KAHE

For all other needs, the Kahe menu provides you with all the means to find the right information to contact us !





USAGE

CHARGING THE BATTERY OF THE KAHE POD 600 ----	25
POWERING ON THE KAHE POD 600 ----	26
ATTACHING THE INTERFACES ----	27
ACCESSORY REPLACEMENT ----	28
PROTECTION GRID ----	29
FIXING AN ACTION CAM IN UNDERWATER SCOOTER MODE ----	30
BATTERY CHARGING DURING MOTOR USE ----	31
EXTERNAL ANTENNA ----	32
ONBOARD INTELLIGENCE ----	33

CHARGING THE BATTERY OF THE KAHE POD 600

It is recommended to fully charge the battery before the first use, as well as the remote control battery.

The battery of your Kahe POD 600 is integrated into your product. You should never open the Kahe POD 600. To recharge the battery, only use the charger supplied with your product or a charger dedicated to your equipment and sold by Kahe. At any time, you can access the battery charge status through the application on your phone (see p. 21) or through the voltmeter on the remote control. The battery must not be modified or disassembled under any circumstances.

To recharge your battery

- Plug the charger into a suitable power outlet (the indicator should light up green).
- Make sure the Kahe POD 600 is dry and especially the charging port.
- Connect the connector to the charging port of the Kahe POD 600 (at the front above the product).
- If the battery needs to be charged, the indicator will turn red. If it's already charged, the indicator remains green.
- When the battery is fully charged, the indicator turns green: the connector can be unplugged.

The battery charging time is approximately 4 to 5 hours.
To recharge the remote control, see page 11.

NOTE

The charging port is waterproof and protected against oxidation, it does not need any protection underwater !



IMPORTANT

The charger may become hot when charging, between 50°C and 70°C on the surface depending on the ambient temperature. Do not cover the charger when plugged in.



charging



charged

POWERING ON THE KAHE POD 600

To power on your Kahe POD 600, simply turn on the paired remote control (see pages 9 and 10). Communication will then be established automatically, and your electric motor will be ready for use!

Your Kahe POD 600 automatically enters deep sleep mode when it is not in use and the remote control is turned off. It then consumes almost no energy.

It is also worth noting that the Kahe POD 600 will automatically stop after a few seconds if the propeller is not submerged in water: this is a completely normal safety feature!

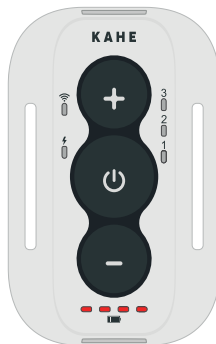

2 seconds

ATTACHING THE INTERFACES

The Kahe POD 600 features on its upper part a mounting area for various interfaces, allowing for the installation of different supports and accessories. The change can be done without tools.

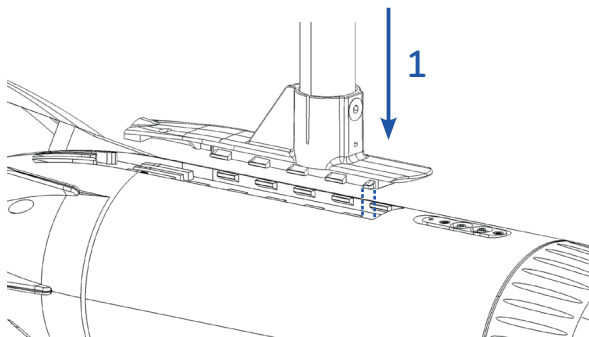

1 - Insert the interface into its slot, with the first narrow tab at the very front

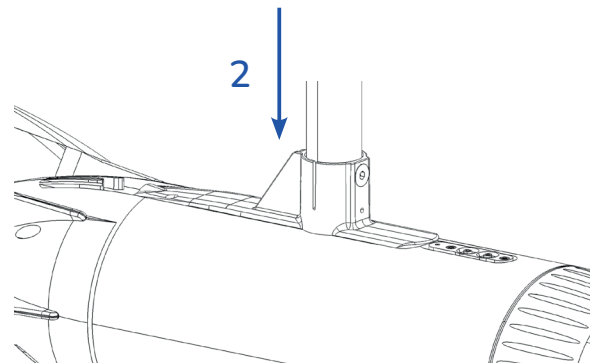

2 - Press the interface firmly into the bottom of its slot by gently pushing downwards

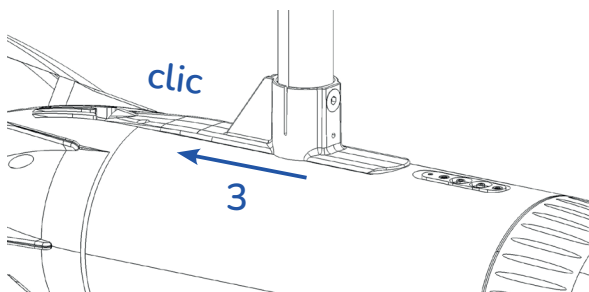

3 - Slide the interface backwards until it clicks into place

NOTE

This attachment system is designed to act as a fuse in the event of a significant impact: the interface will pop out of its housing to protect the Kahe POD (which floats). However, it is still possible to completely secure the interface using a small screw located at the rear of the interface (a slot is provided for this purpose).

ACCESSORY REPLACEMENT

Removing an attachment fixed to the Kahe POD 600 is very easy and can be done without any tools:

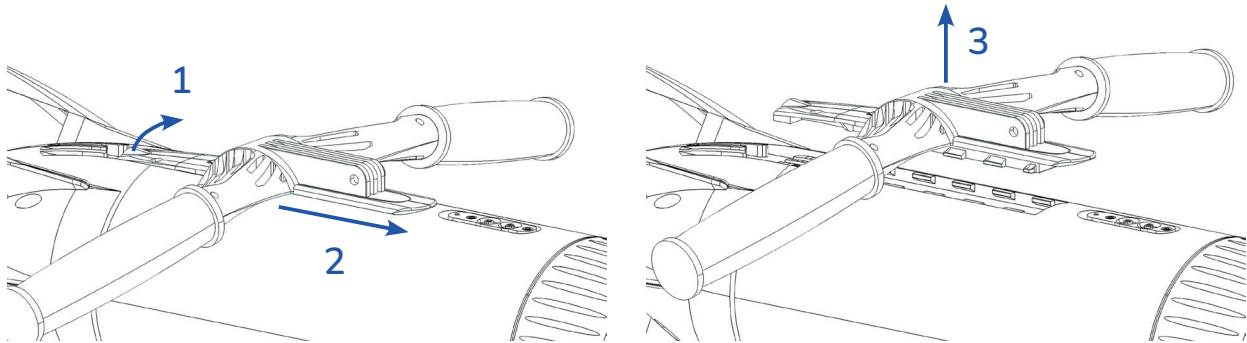

1 & 2 - Lift the rear of the interface with your finger while pushing it forward

3 - The interface detaches from the Kahe POD, allowing you to attach another accessory or store your product !



PROTECTION GRID

Your Kahe POD 600 features a shrouded propeller which provides a high level of safety by making the propeller less accessible. However, you can also add a complete upstream and downstream protection grid to further enhance the safety of the product. This protection grid is available as an option and is included with the snorkeling handle. We ask you to always use the protection grid when using your Kahe POD 600 in close proximity to other people, or when you yourself are nearby, for example, when using it as an underwater scooter with the snorkeling handle.

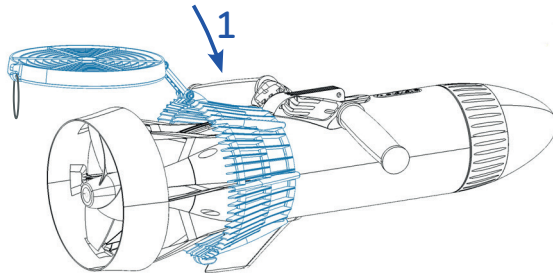

1 - Insert the grid around the Kahe POD 600

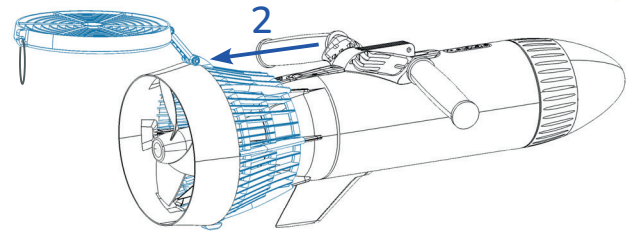

2 - Push the grid back against the propeller shroud

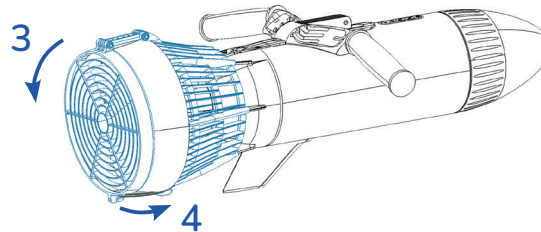

3 & 4 - Fold the rear grid downwards, then lock it with the elastic

FIXING AN ACTION CAM IN UNDERWATER SCOOTER MODE

When using your Kahe PDO 600 in underwater scooter mode, you can attach a compatible waterproof Action Cam to the top of the snorkeling handle to film the underwater environment. We have integrated a GoPro-compatible mounting system, which allows you to attach a large number of waterproof action cameras on the market. This way, you can immortalize all your underwater sessions. Be careful to follow the method of attaching your camera, which is specific to each brand and each installation.

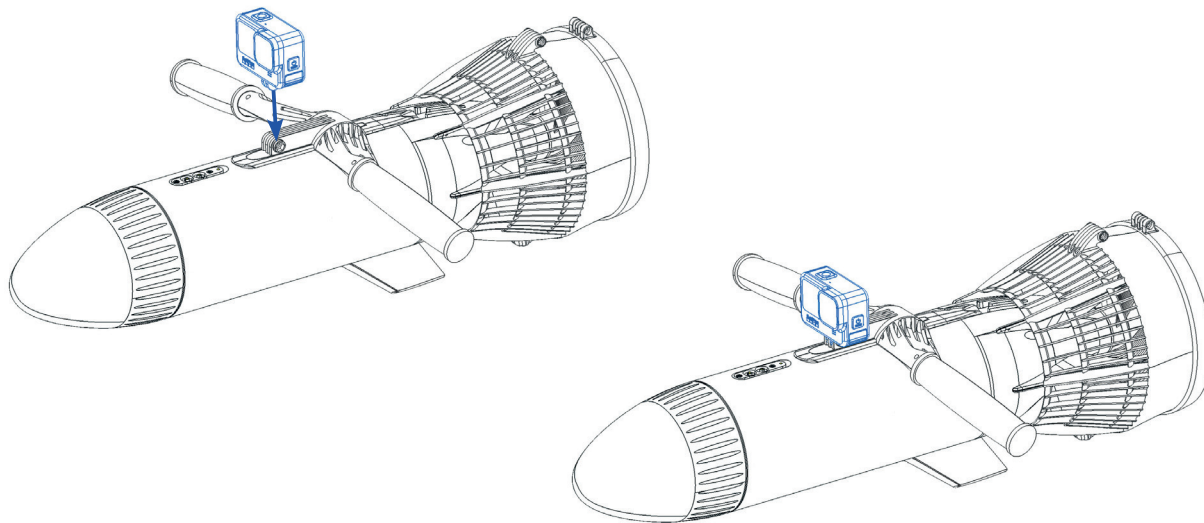

BATTERY CHARGING DURING MOTOR USE

It is possible to recharge the battery of the Kahe POD 600 with a dedicated charger, even while using the motor on a watercraft.

To do this, it is necessary to use the optional waterproof charging cord Kahe Nautic. It has two O-rings and two screws to firmly and waterproofly attach it to the charging port of the Kahe POD 600. Make sure to connect this waterproof connector when the product and the cord are completely dry. You will need to use a hex key to attach the connector.

We offer an optional direct current (DC/DC) charger that can be connected to continuous voltage sources between 12V and 24V. The maximum charging current accepted by the Kahe POD 600 is 10 amps. Make sure to use only Kahe Nautic chargers, as they are the only ones perfectly suited to your equipment and its lithium battery (type 6S4P).

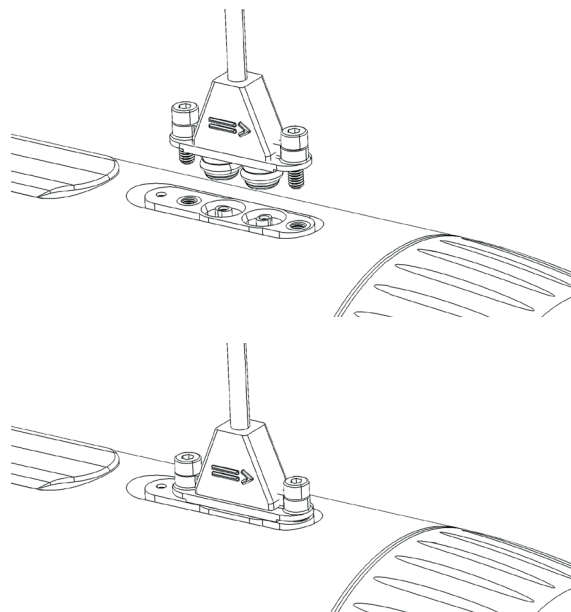
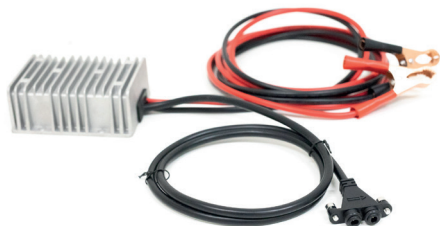

EXTERNAL ANTENNA

The Kahe POD 600 has a built-in antenna capable of establishing a connection with the remote control in a wide range of situations.

However, radio waves are greatly attenuated by conductive media, especially saltwater (and by metallic or carbon hulls...). In some cases (Kahe POD 600 deeply immersed in seawater, or under a metallic or carbon hull), it may happen that the connection with the remote control is not established correctly. To overcome this type of situation, and to allow you to use your Kahe POD in any circumstances and on any watercraft, we have provided an external antenna port.

Simply connect any thin electrical wire (with insulated sheathing) to it and let a portion of this wire protrude out of the water (about twenty centimeters is sufficient). You can also leave the antenna fully immersed but press the end (about twenty centimeters) against the (non-metallic) hull of your watercraft. This way, you will have no communication problems with the remote control !

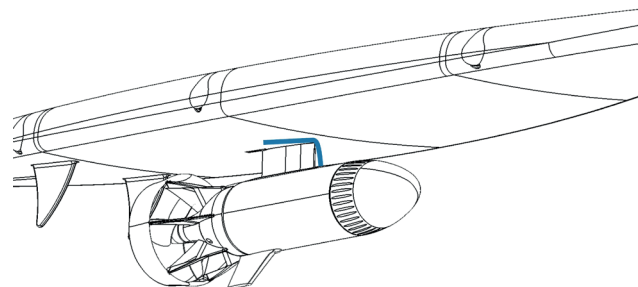
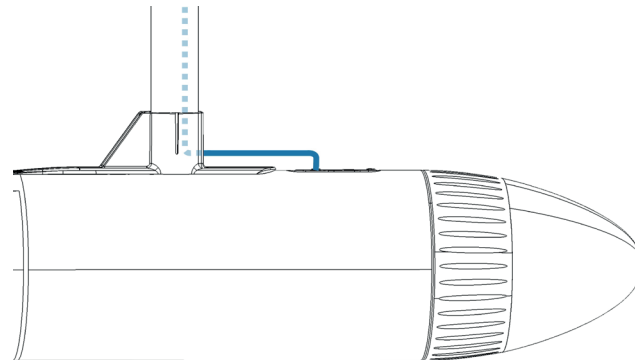

ONBOARD INTELLIGENCE

Your Kahe POD is equipped with advanced features allowing you to focus on your activity safely.

Automatic Shutdown out of Water: Your Kahe POD automatically stops within a few seconds when it is out of the water. This prevents any accidents and preserves your product.

Automatic Shutdown in Case of Loss of Connection with the Remote Control: The motor stops when the remote control is turned off, or when the connection is no longer established. If you wear the remote control on your wrist or if you are equipped with a safety beacon, in the event that you fall into the water while your motor is running, the propulsion will automatically stop within a few seconds due to the loss of connection.

Automatic Shutdown in Case of Propeller Blockage: The motor stops when the propeller is blocked or heavily slowed down by an obstacle.

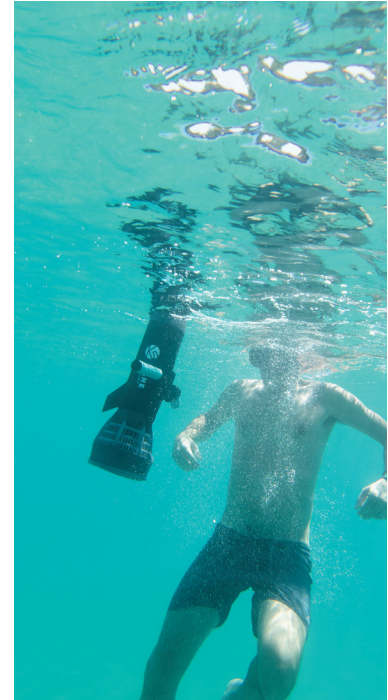



MAINTENANCE

BEFORE GOING INTO THE WATER ----	35
NAVIGATION ----	36
RETURN TO DRY LAND ----	37
BATTERIES & STORAGE ----	38

BEFORE GOING INTO THE WATER



Before each session, carefully inspect your watercraft and your Kahe POD to ensure that everything is in working order.



Your Kahe POD must be securely attached to your watercraft, with the fixing accessories fully engaged. The propeller shroud must be in perfect condition. Nothing should obstruct the propeller from rotating. The integrity of your POD must be ensured (no cracks or holes), and the front nose cone must be perfectly sealed with the body of the product. Make sure that your battery and remote control are fully charged before departing!

IMPORTANT

If you notice that a part of your Kahe POD is broken or damaged, do not use it anymore. Contact the Brand's or your Distributor's Customer Service immediately to resolve the issue.

NAVIGATION

Continuously monitor that there is enough water under your watercraft (approximately 40 cm, depending on the type of watercraft you are using) to prevent the Kahe POD from rubbing against the bottom or receiving an impact: this would damage your Kahe POD.

Do not operate your Kahe POD out of the water. Always keep the remote control with you, never in the watercraft, unless you have programmed a safety beacon that you keep on you. The remote control or the beacon are safety features: propulsion stops if the remote control or the beacon are out of range. For paddle sports, if you do not have a beacon and you attach the remote control to your paddle, use a paddle leash. In snorkeling (underwater scooter mode), use a leash or activate safety via the application (see page 17).



IMPORTANT

Be respectful of other users: avoid collisions and stay away from swimming areas.

RETURN TO DRY LAND

When returning from your navigation, as soon as you no longer need the motor, it is advisable to turn off the remote control (long press of 2 seconds on the central button), which deactivates the Kahe POD 600.

You should then rinse your Kahe POD thoroughly with fresh water to clean it, remove any sea salt if necessary, or any dirt that may have become stuck. It is also a good idea to do the same with the remote control. Sometimes, algae or other dirt may remain attached to the shroud or propeller despite rinsing. For your safety, make sure your remote control is turned off and stored securely before cleaning it.



Your equipment should be stored in a dry place and protected from direct sunlight and any sources of heat.



IMPORTANT

The Kahe POD 600 must be completely dry (especially at the charging port) before recharging it. It is absolutely essential to avoid the presence of water at the connectors during charging !

BATTERIES & STORAGE

Your battery uses lithium-ion technology, which gives you an excellent balance between autonomy and weight.

However, as is normal, its performance slightly decreases over time with charge and discharge cycles. Below are some tips to maximize its performance.

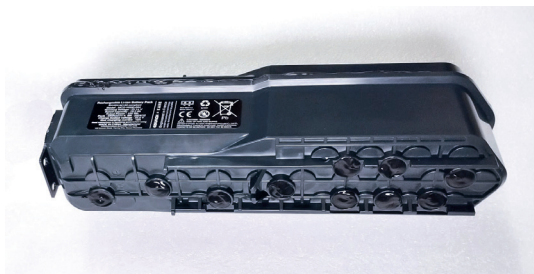

A battery that is fully discharged can be irreversibly damaged. We have designed the propulsion to cut off when there is actually still some energy left in your battery. However, please note that an unused battery still discharges little by little, even if it is not connected.

Therefore, it is important to quickly recharge a battery that has been deeply discharged (up to the automatic cutoff of the Kahe POD 600, for example).

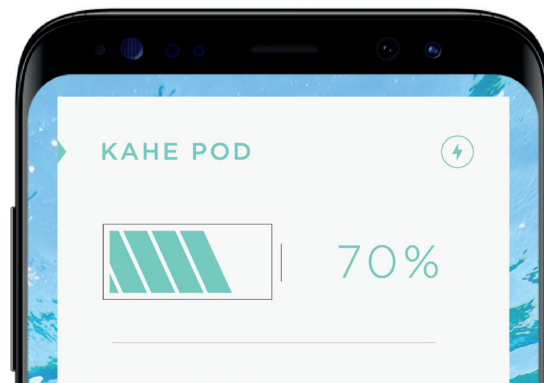

When not in use for several months, your battery should be stored with a charge level between 50% and 75%. This will maximize its lifespan. The same goes for your remote control: do not store it if the red battery indicator is flashing, it is better to recharge it a bit beforehand, ideally until two out of the three green charge indicators are continuously lit !

Your equipment should be stored in a cool and dry place (but frost-free, ideally between 10°C and 20°C), protected from direct sunlight and any sources of heat.



SPECS

TECHNICAL SPECIFICATIONS ----	40
DECLARATION OF CONFORMITY ----	41

TECHNICAL DATAS

KAHE POD 600 outboard electric motor

MOTOR : Direct drive - brushless outrunner motor 800 watts

BATTERY : 6S4P lithium-ion (M52 LG Chem cells) - capacity 425 Wh - maximum charge current : 10 amperes

ESC : High frequency 8 kHz - 50 amperes max

IP RATE : IPX8 at 5 meters

CHARGE : 25.2V DC - 10 A max 

RADIO : BLE (remote) operating frequency 2402 MHz to 2480 MHz / Power -14.41 dBm
433 MHz (propulsion & remote) operating frequency 433.13 MHz
Power -14.46 dBm (propulsion) & -14.90 dBm (remote)

Li-ion charger

WARNING: For the purposes of recharging the battery, only use the detachable supply unit provided with this appliance

INPUT : AC 100-240 V

OUTPUT : CC 25.2 V 4.0 A

CHARGING TIME* : 5 hours

* estimated charging time from 10% to 90%

CE & UKCA DECLARATION



COMPANY & ADDRESS : Motion Concept Group - 10 avenue de la forge - 33680 Lacanau - France

Declares that the following nautical electrical assistance:

COMMERCIAL NAME : Kahe Pod 600

TYPE : Nautical Electric Motor

complies with the essential safety requirements applicable to it :

- Directive Machine 2006/42/CE
- Directive RED 2014/53/UE
- Directive LVD 2014 / 35 / EU
- Directive EMC 2014/30/UE
- Directive RoHS 2011/65/UE
- Normes Batteries IEC 62133-2:2017 & UN 38.3

Hereby, Motion Concept Group declares that the radio equipment Kahe POD 600 is in compliance with Directive 2014/53/ EU and with UK Radio Equipment Regulation 2017. The full text of the EU and UK declarations of conformity are available at the following internet address : <https://kahe-nautic.com/pages/downloadkahe>



**MOTION
CONCEPT
GROUP**

Done at Lacanau
January 15, 2025

Nicolas Quendez
President of Motion Concept Group

Motion Concept Group - 10 avenue de la Forge - 33680 Lacanau
SIREN 834837510 - www.motionconcept-group.com



download manual
in different languages

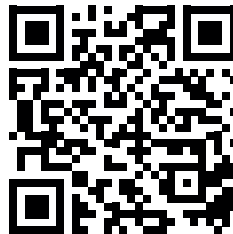

[kahe-nautic.com
/pages/downloadkahe](https://kahe-nautic.com/pages/downloadkahe)

