

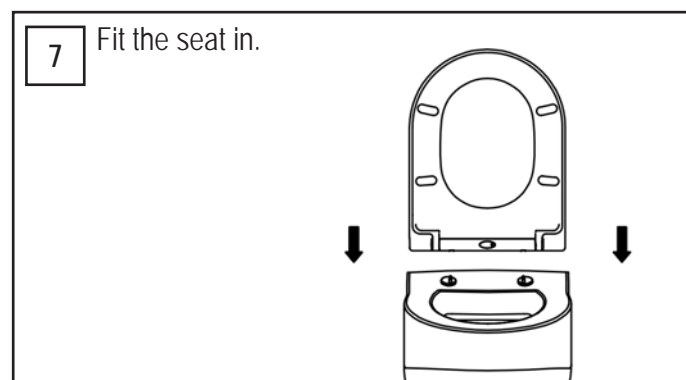

Toilet seat U1002 with LED light

ASSEMBLY INSTRUCTIONS:

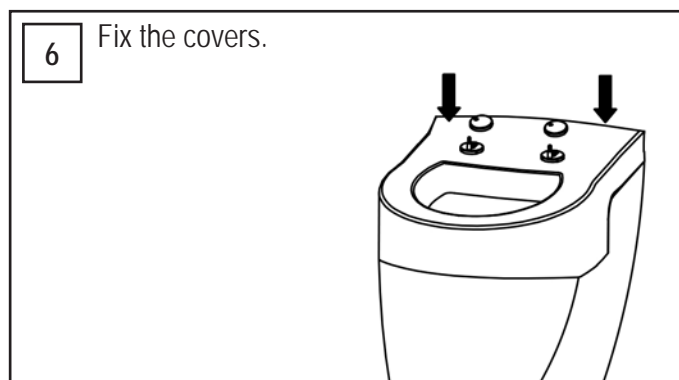
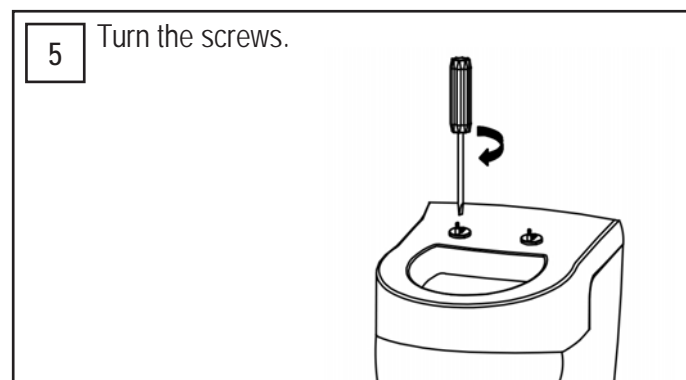
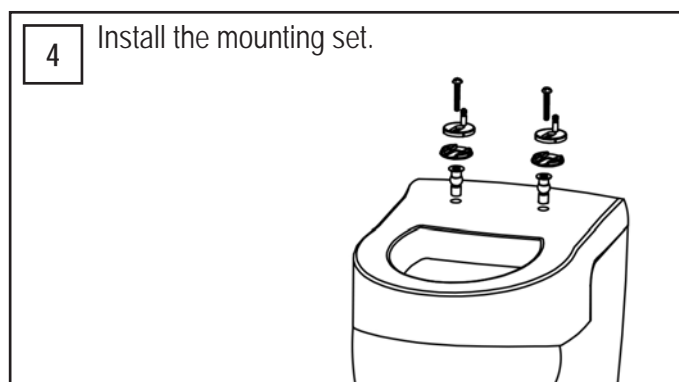
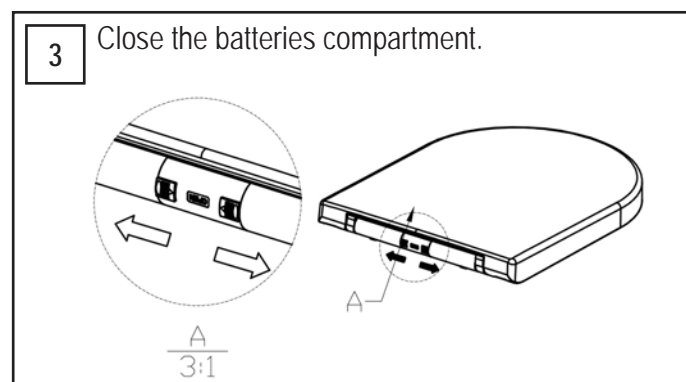
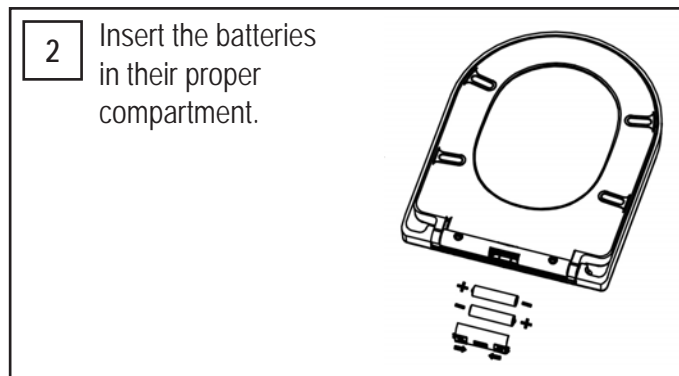
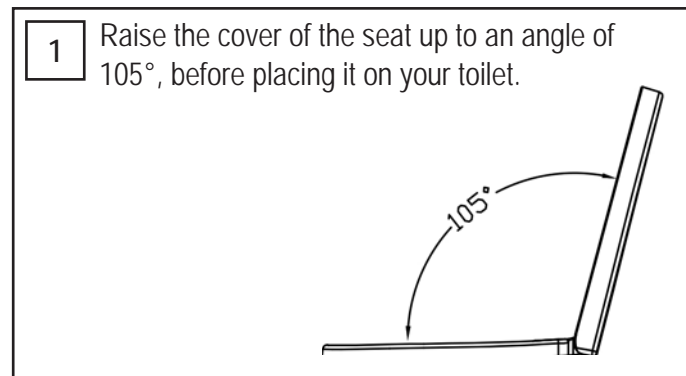

Information about the disposal of exhausted batteries (BattG)

Please carefully read the text below and respect the rules of the disposal of exhausted batteries. The current law doesn't foresee the disposal of batteries as or with domestic waste.

They have to be collected:

- In an official collection point;
- At a licensed shop.

The rule covers every cell providing energy to technological devices (Es mobile phones or Notebooks).

The crossed out wheeled symbol labels batteries and cells which contain dangerous elements for the environment. Every user has to contribute to the defence of the planet with a responsible disposal of exhausted batteries.

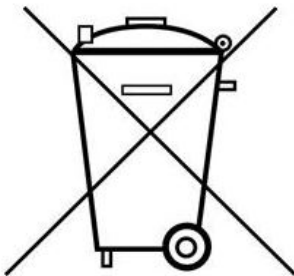

Electric or electronic devices

The disposal of these devices doesn't belong to the domestic waste. They have to be collected in an official collection point of your city.