

SHOWER ENCLOSURE EX506

BERNSTEIN
Living with Style

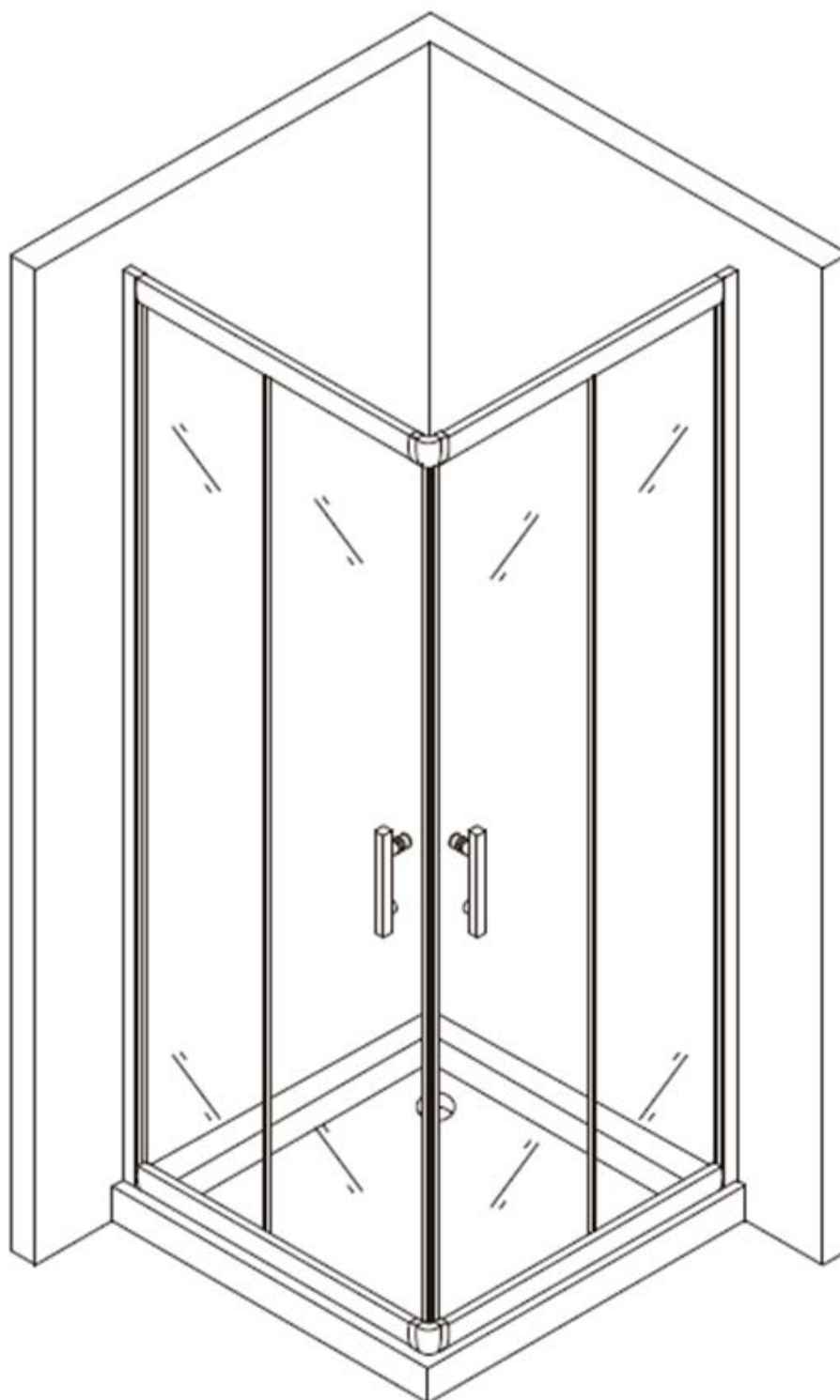

ASSEMBLY INSTRUCTIONS

September 2017

Shower enclosure EX506

TOOLS REQUIRED

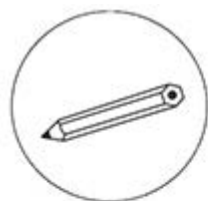

PENCIL



SCREWDRIVER



POWER DRILL

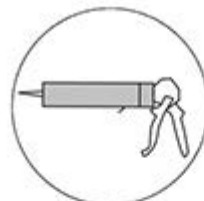

SILICONE SEALANT

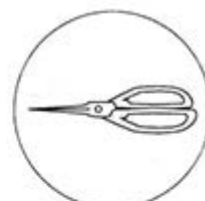

SCISSORS



SPRIT LEVEL



RUBBER Mallet



HEX SCREWDRIVER
(INCLUDED IN DELIVERY)



TAPE MEASURE

INCLUDED IN THE DELIVERY

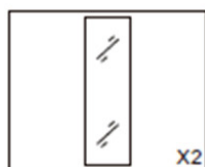

X2

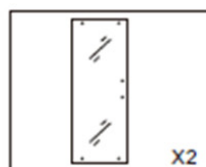

X2

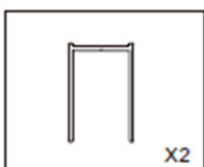

X2

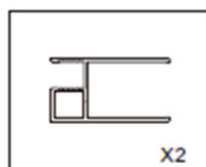

X2

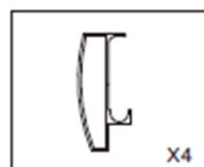

X4

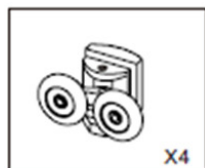

X4

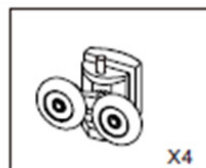

X4

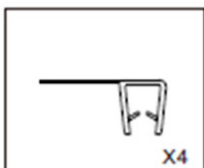

X4

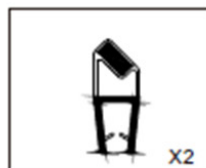

X2

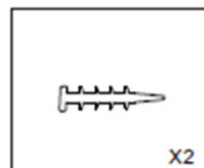

X2

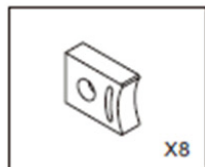

X8

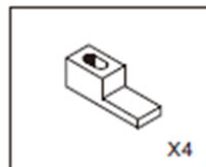

X4

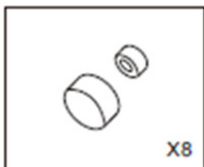

X8

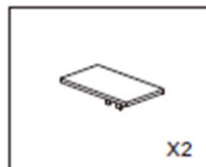

X2

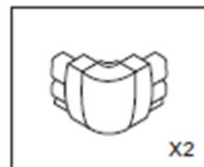

X2

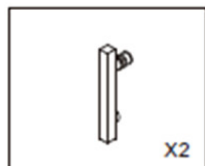

X2

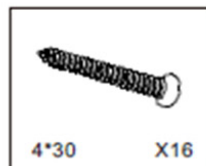

4*30

X16

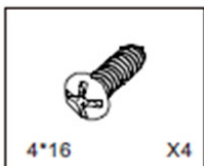

4*16

X4



4*12

X12

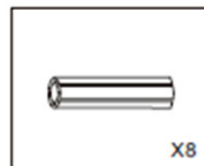

X8

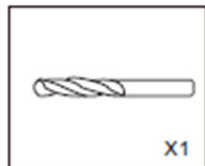

X1

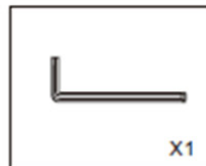

X1

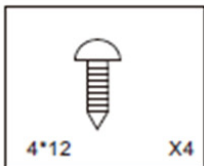

4*12

X4

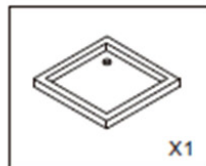

X1

NOTE

Please fix the screws on the surface of the glass manually, not by power drill.

Wall profiles should be arranged 15 mm to the external border of the shower tray, or according to the approximate value of the segment A (see image below)

WARNING

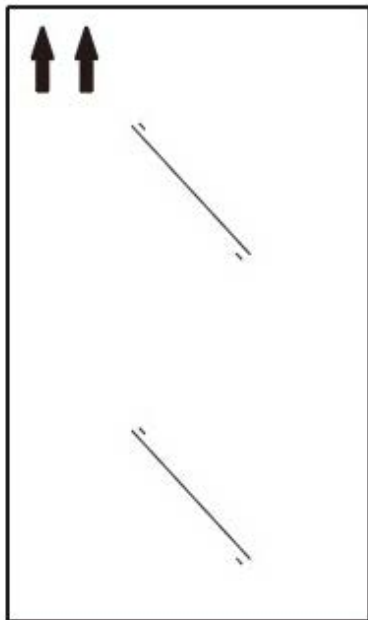

Upward arrow

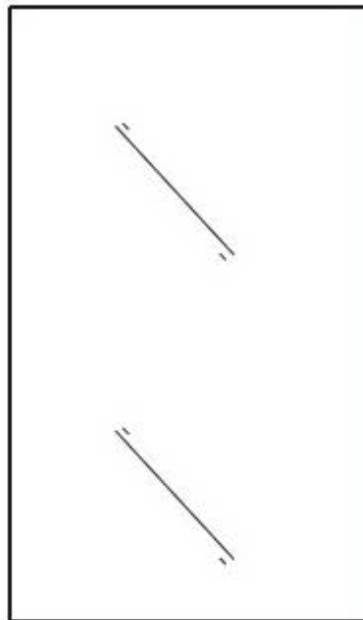

No arrow – Usable on both sides

Please carefully consider that some of our shower enclosures are reversible.

In these cases no label will show the internal and external parts.

Shower enclosure EX506

ASSEMBLY:

Arrange the profiles (see image). Mark holes position by means of a spirit level and a pencil.

Drill the holes and fix the profiles by means of the wall plugs. Please use wall plugs compatible with your wall.

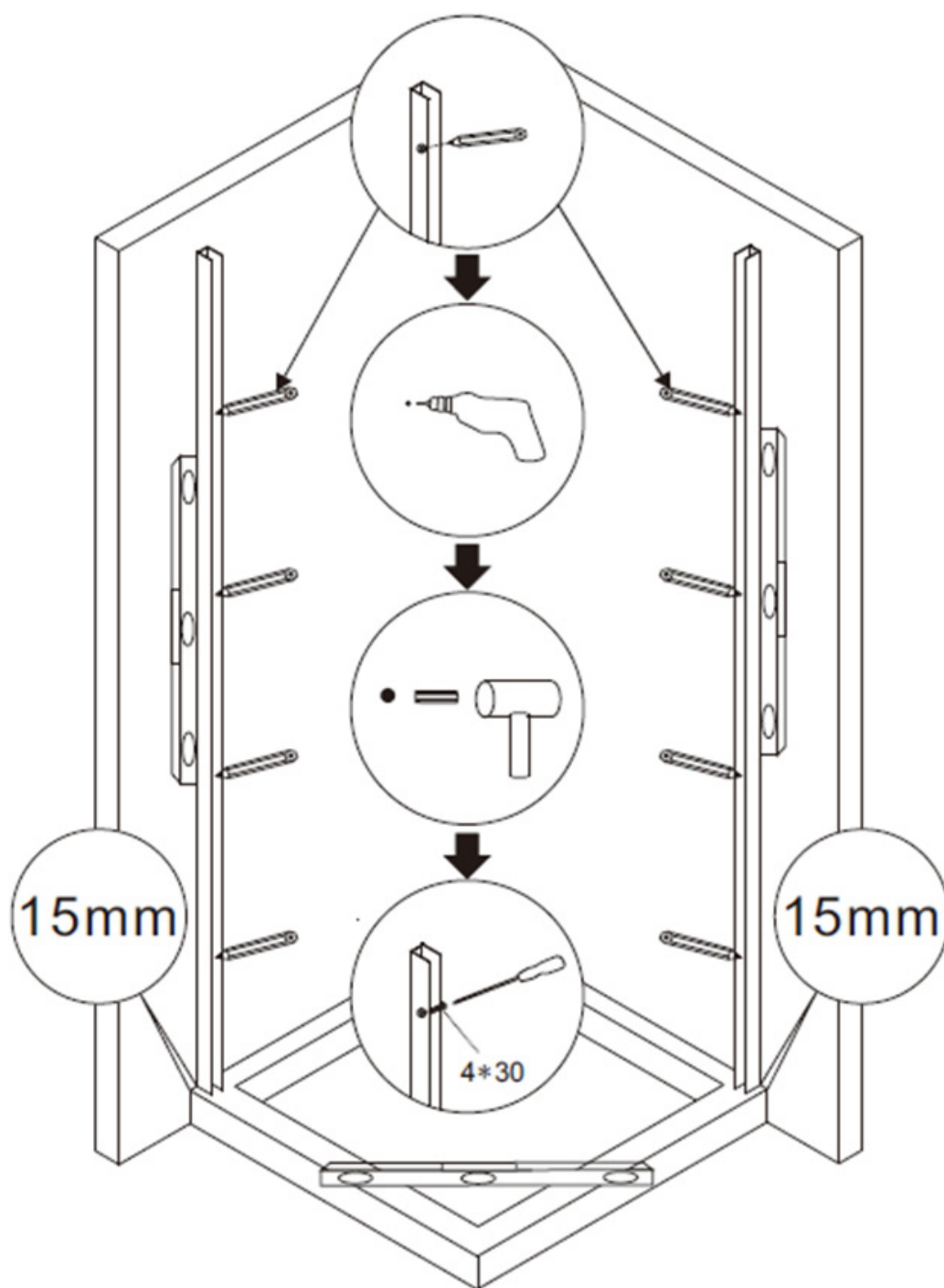

Secure the aluminium profile to the rail with some screws 4*30. (As showed in the image)

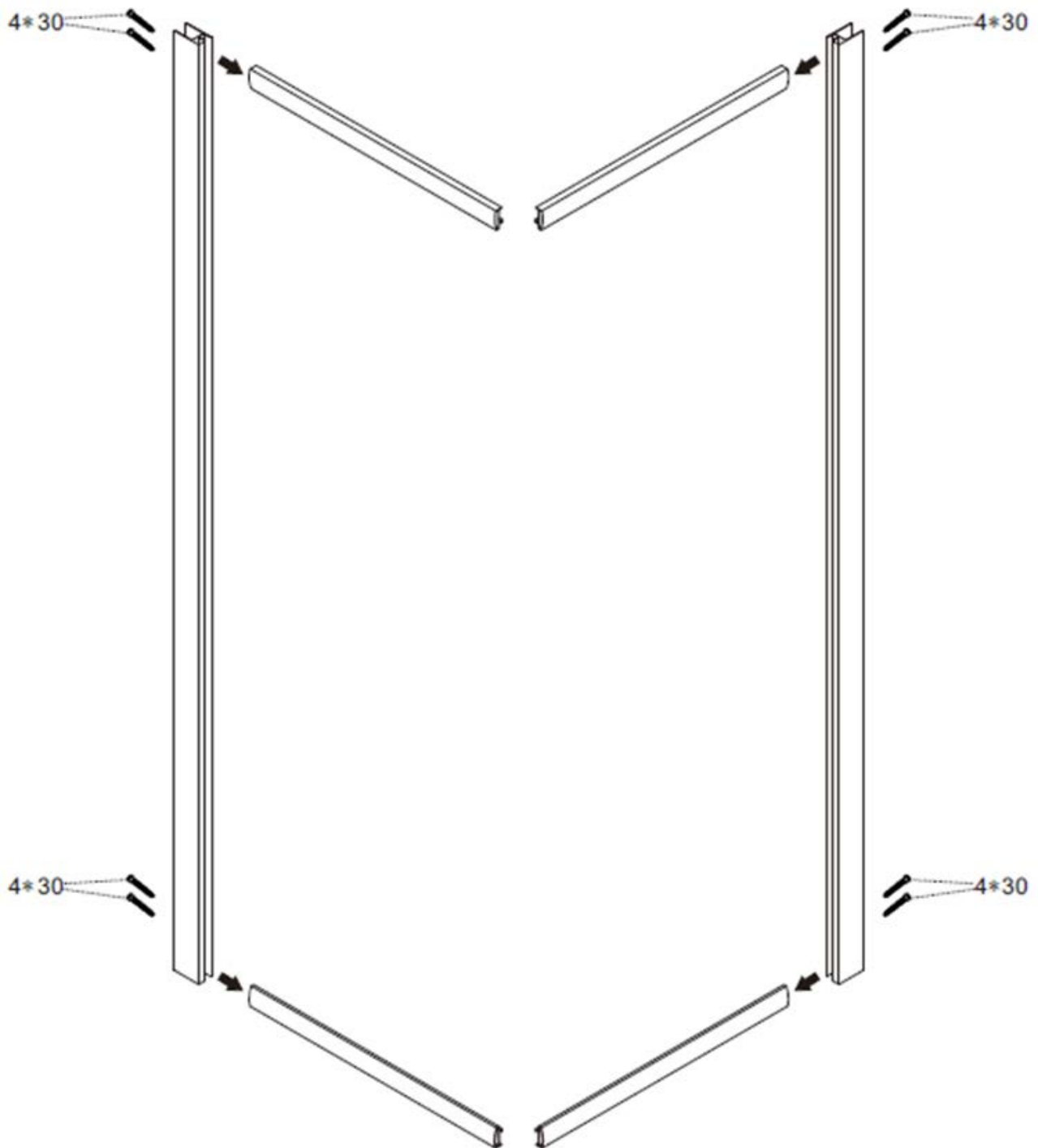

Shower enclosure EX506

Insert the glass elements in the aluminium rail. (See image below)

Make sure to place the glass in the wall profile and, only later, place the joints between the glass and the profile, sliding them from the upper to the downer side.

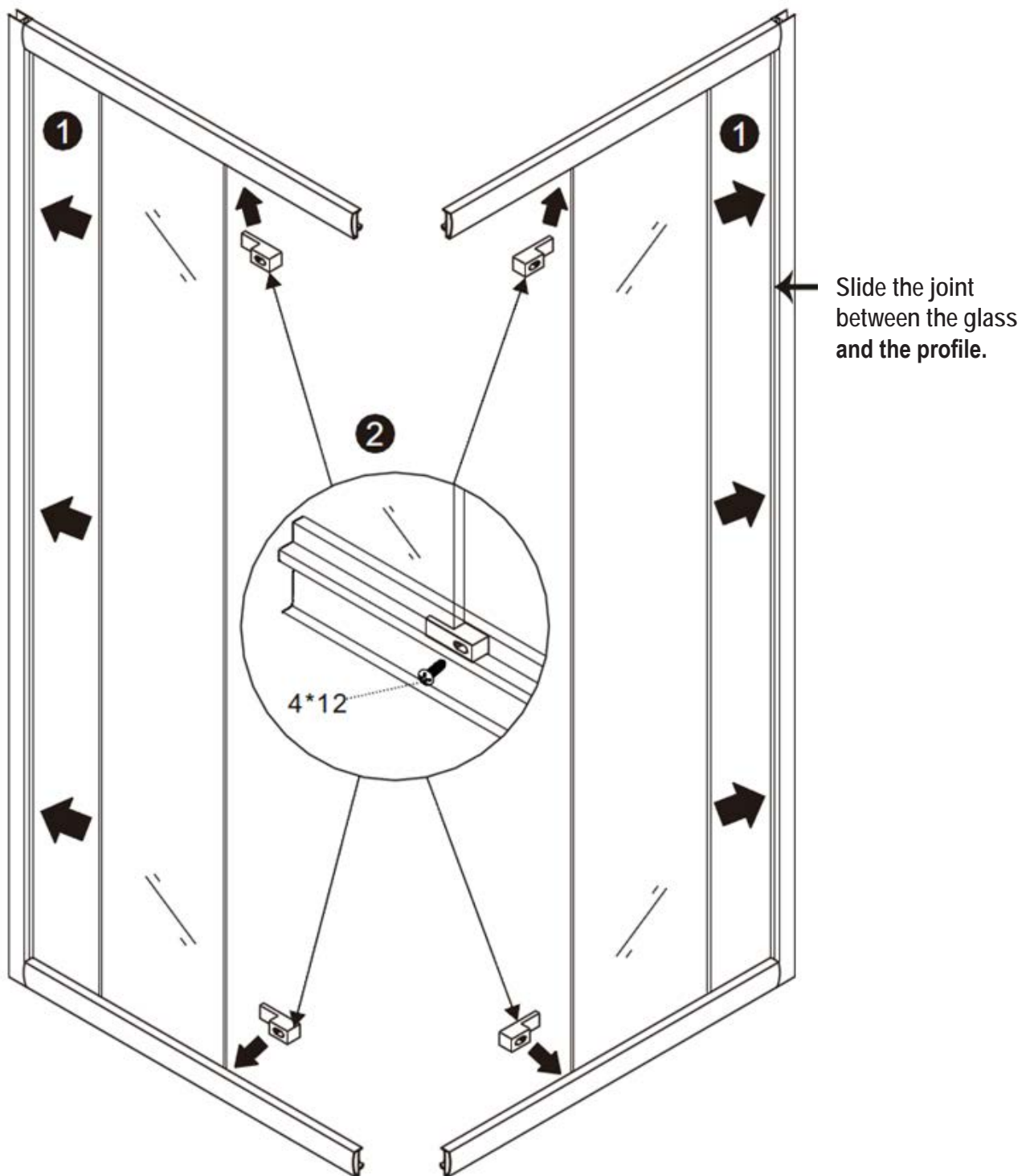

Insert the corner in the wall profile (See image)

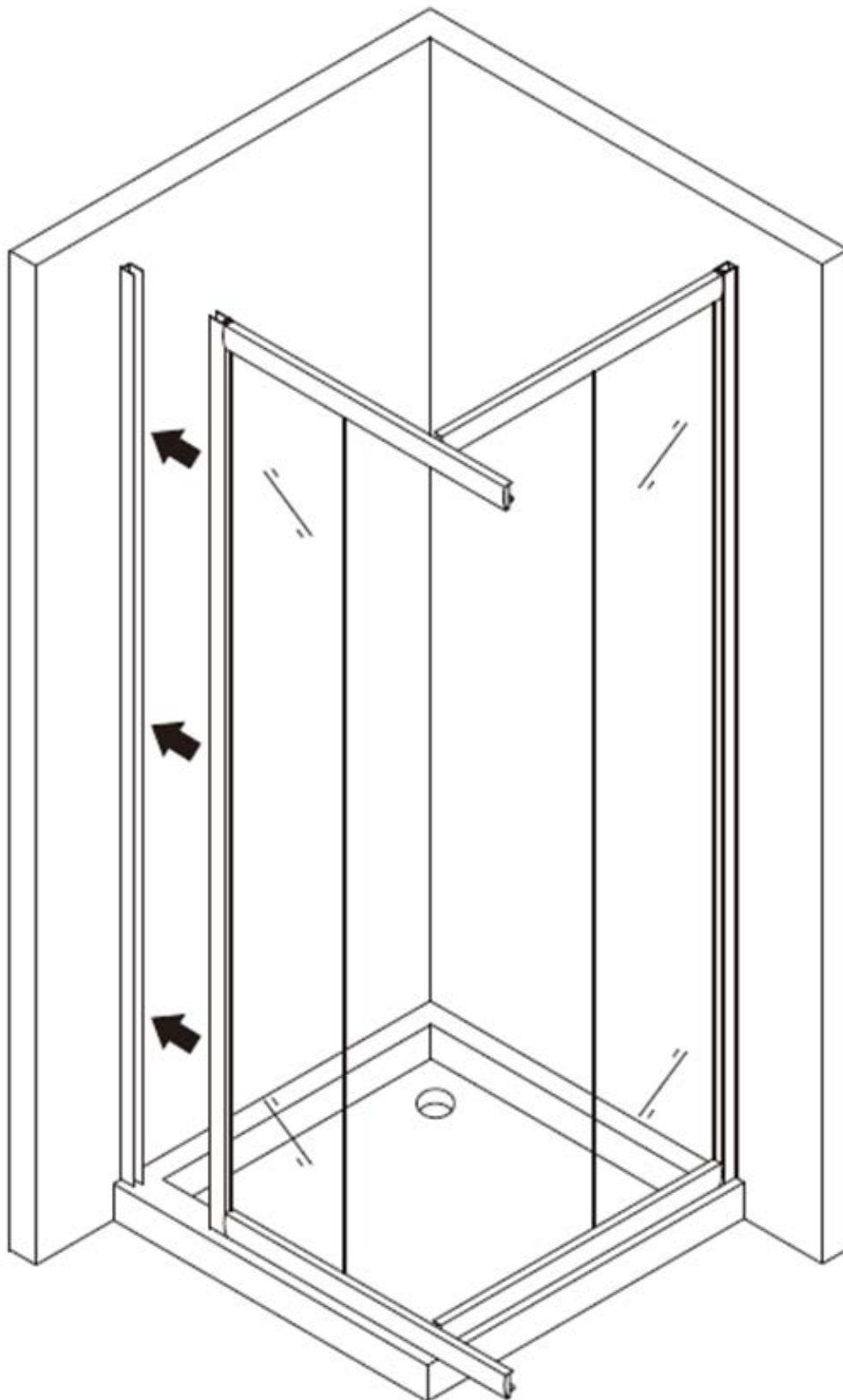

Shower enclosure EX506

Connect the two elements by means of the plastic supports. (See image below)

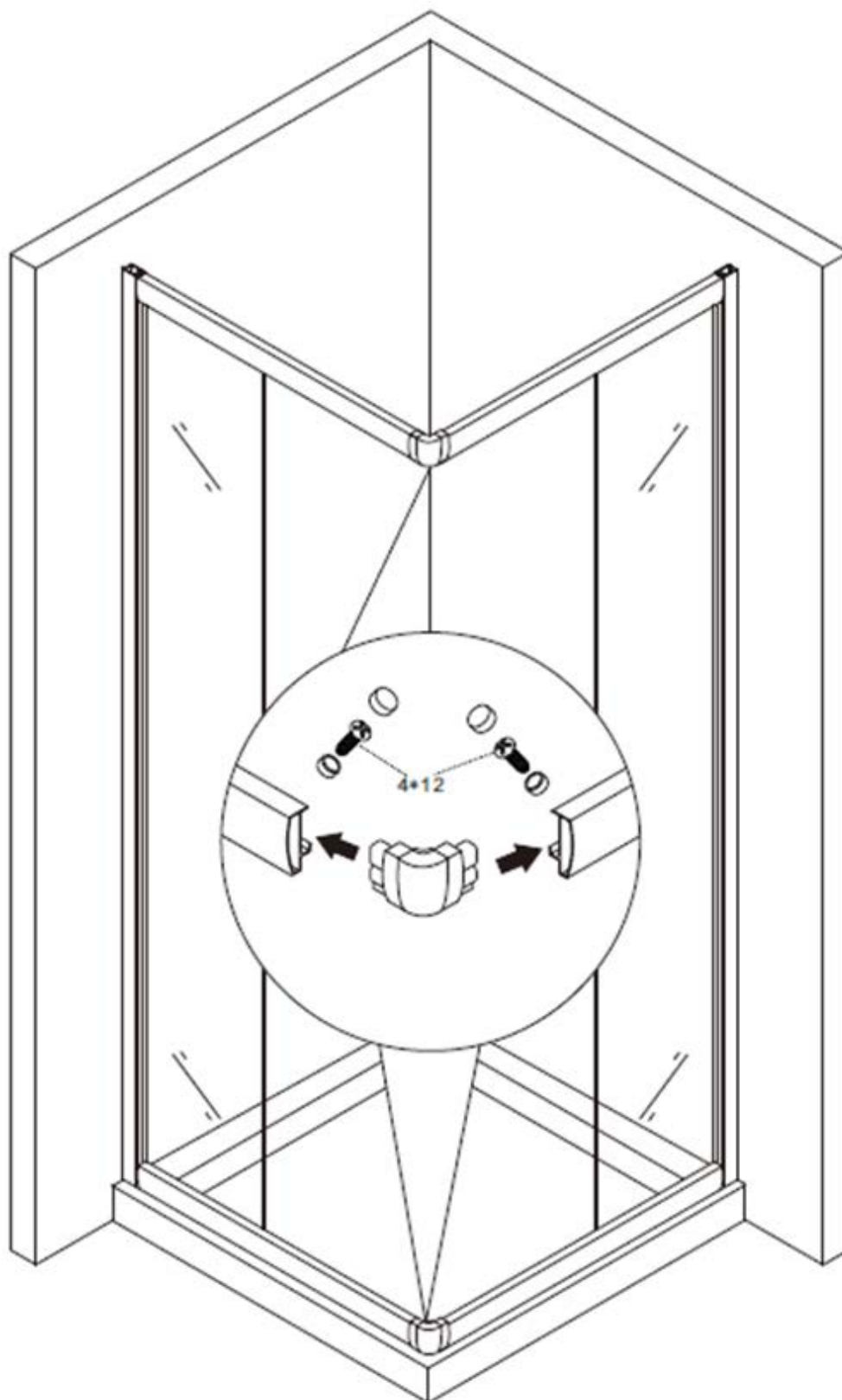

Install the wheels with the button downside and without button upside.

NOTE:

The upside wheels are adjustable. They can be adjusted by means of a hex screwdriver if they were not sliding correctly.

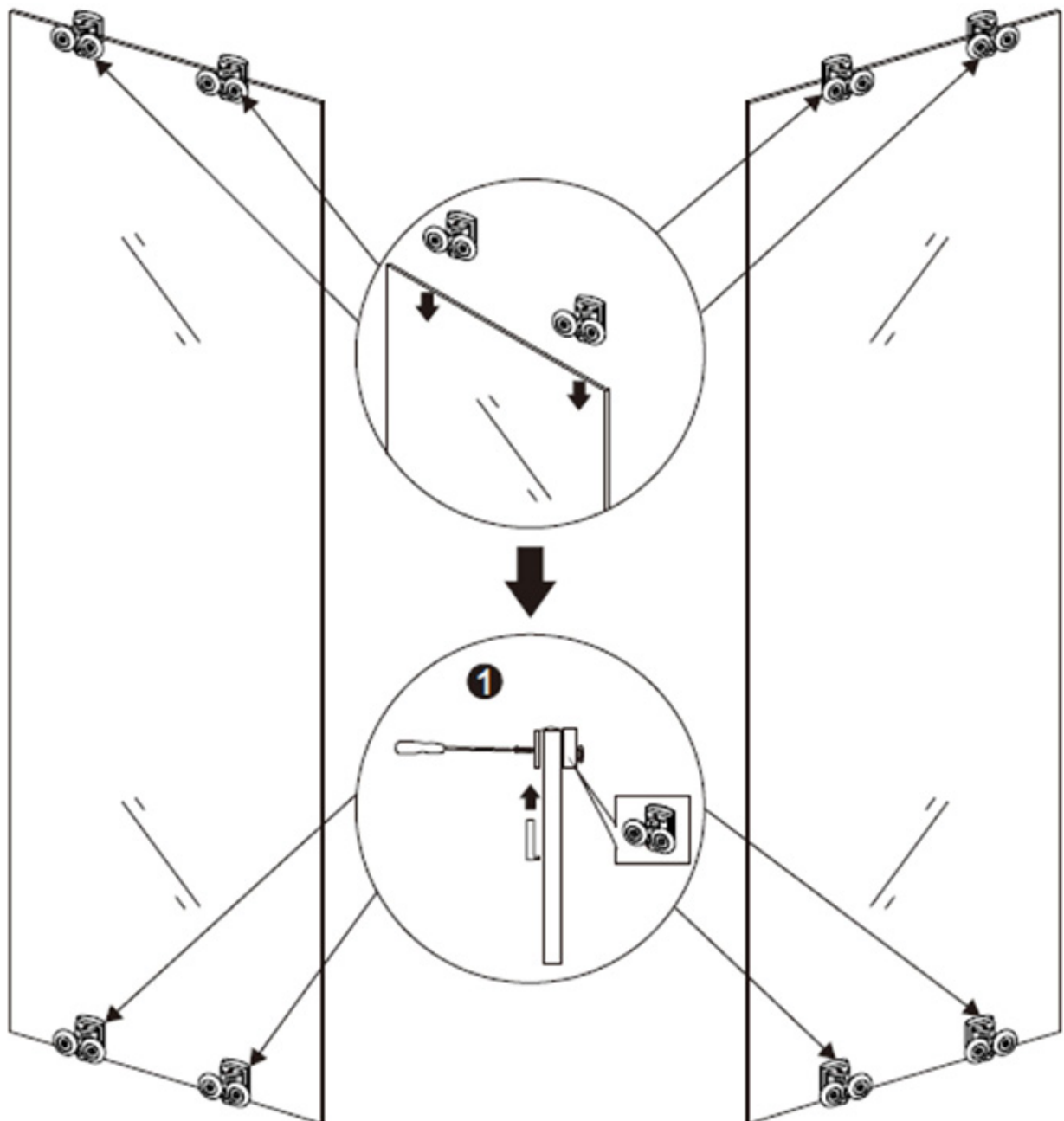

Shower enclosure EX506

Place the door on the aluminium rail.

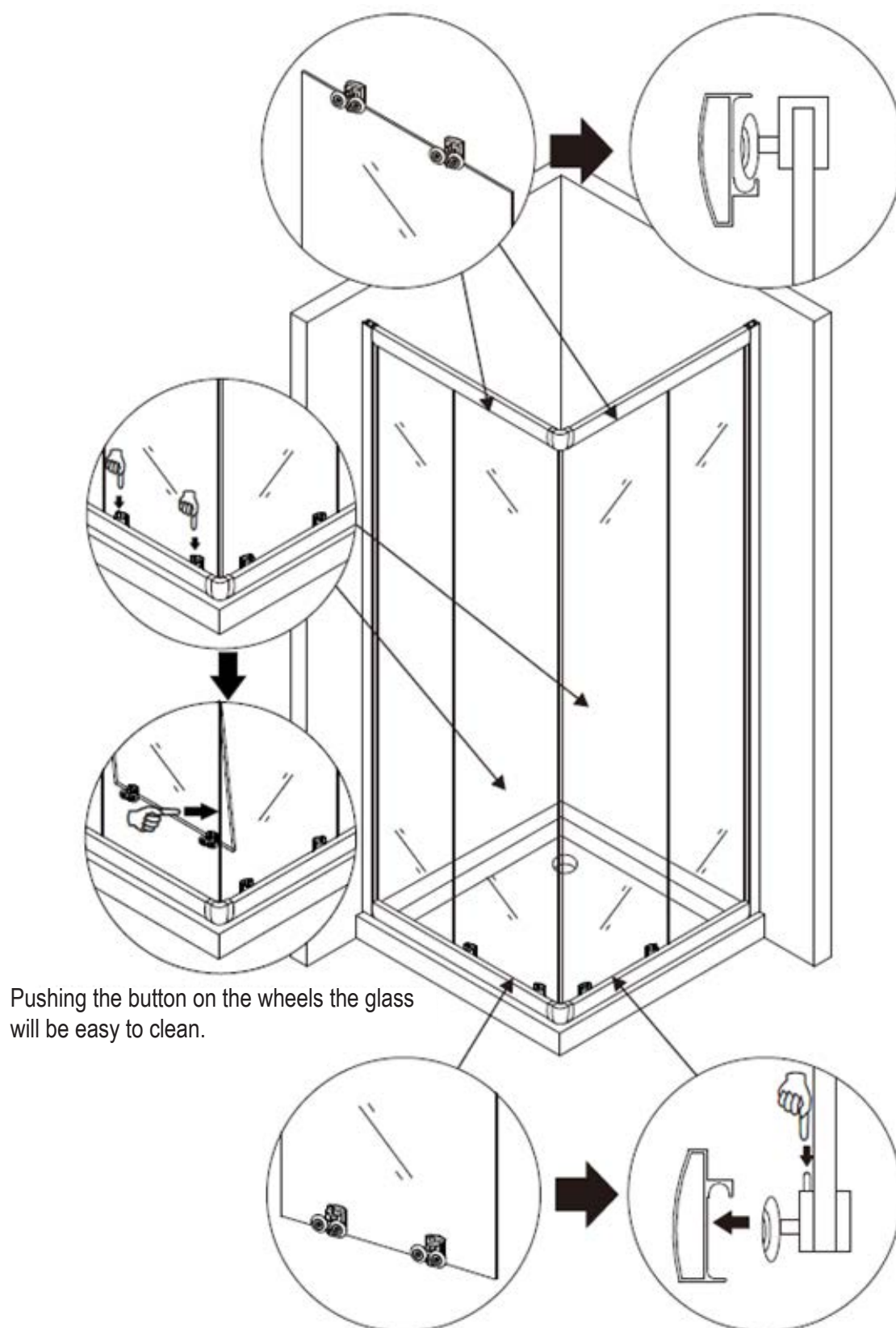

1. Fix the magnetic joints to the door
2. Place the joints between the door and the aluminium profile
3. Drill the holes and connect the glass segment to the wall profile, by means of the screws 4x16
4. Place the cover on the screws

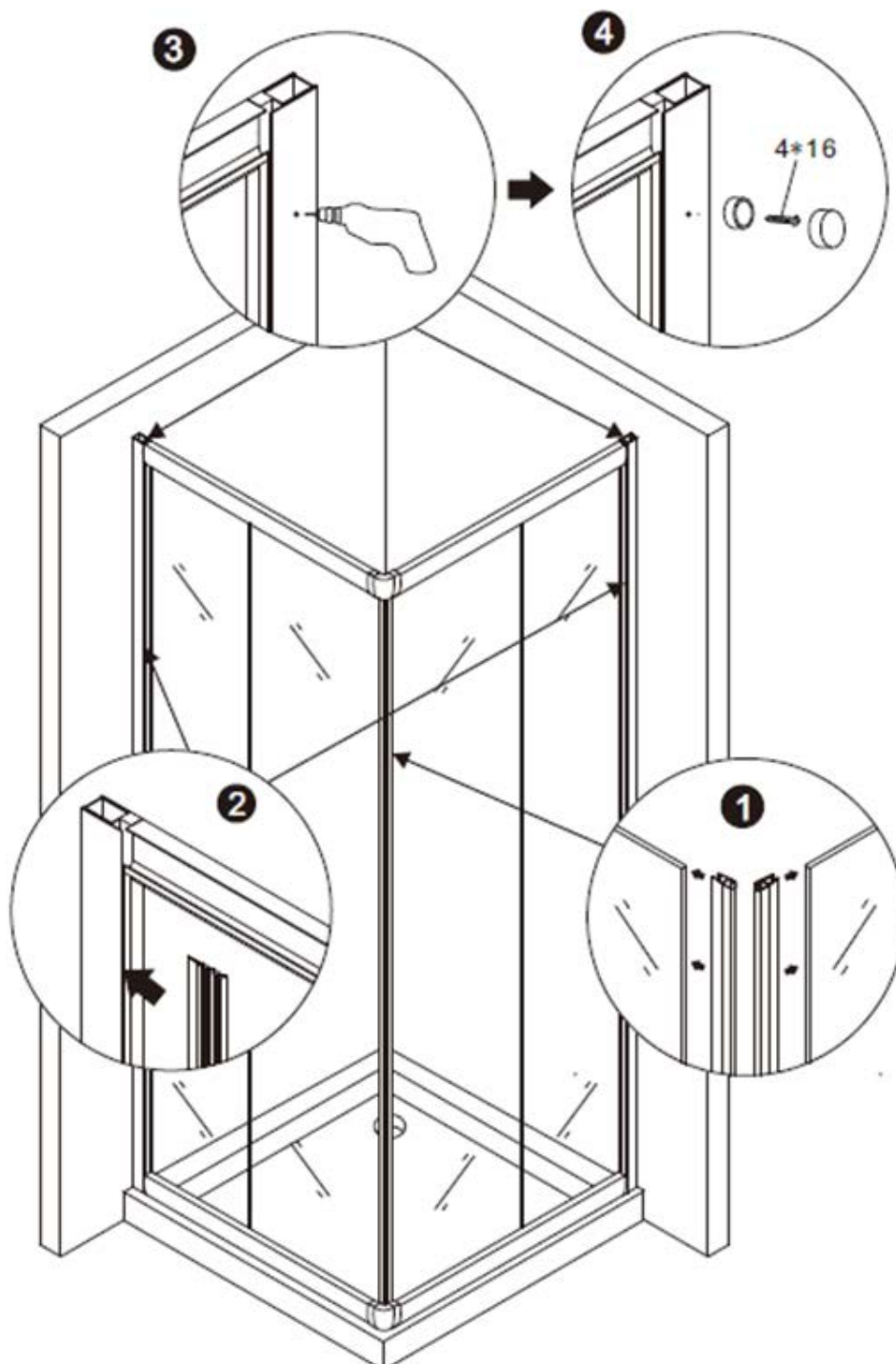

Shower enclosure EX506

1. Fix the wheels block on the rail
2. Screw the door handle
3. Install the joints to the fixed panel and the door
4. Put the protection cover on the aluminium profile.
5. Apply silicone sealant

