

YSER BCD

SPECIAL APPLICATION PROFILE

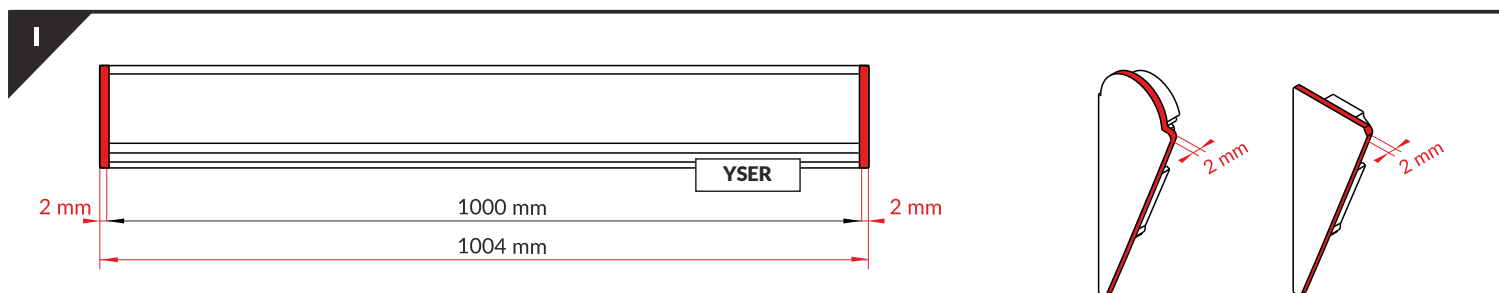

Note! Ending thickness increases the length of the luminaires (+ 2 x 2 mm).

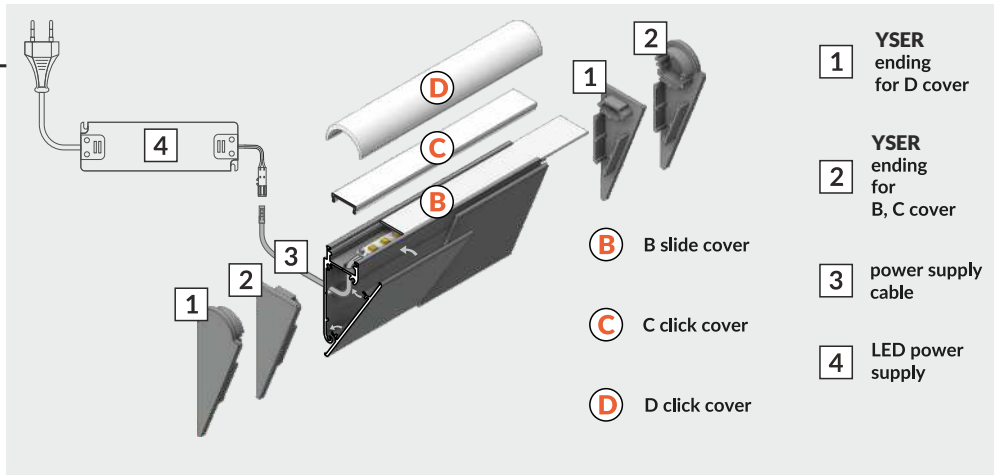
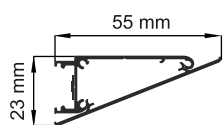
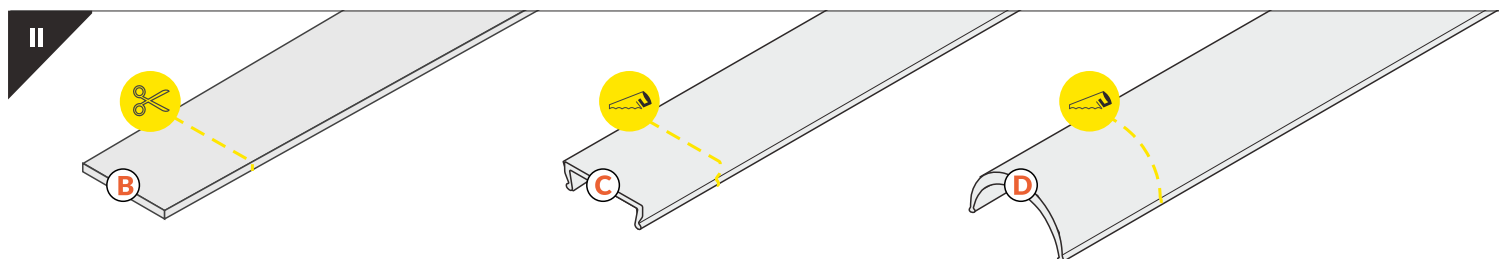

The length of the cover is equal to the length of the profile.

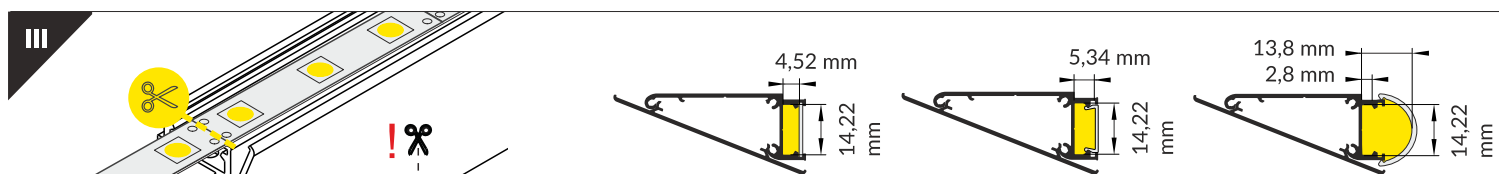

Dimensions of the space to install LED source.

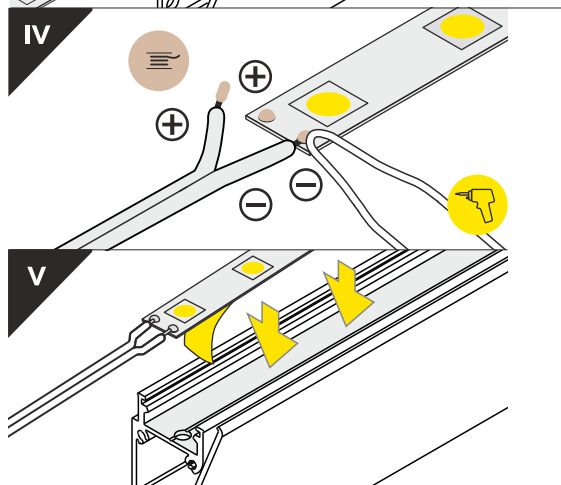

VI

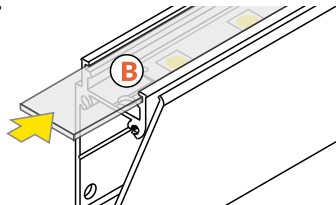

B slide cover

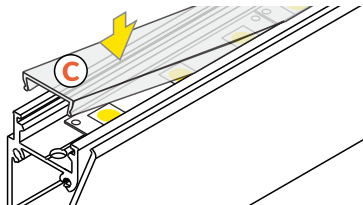

C click cover

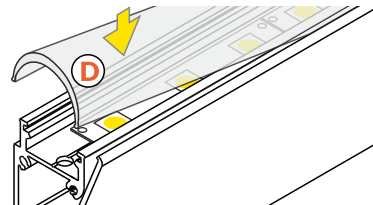

D click cover

VII MOUNTING

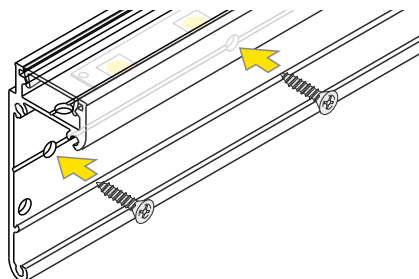

screw

MOUNTING

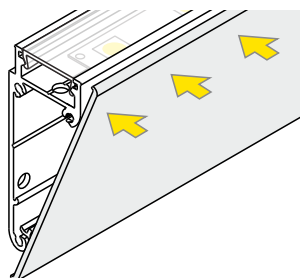
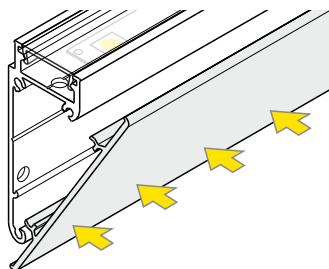

MOUNTING

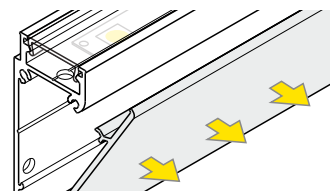
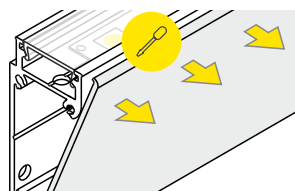

NOTE!
Do not pull the cover by force. A flat tool should be used to remove the cover.

VIII CONNECTORS

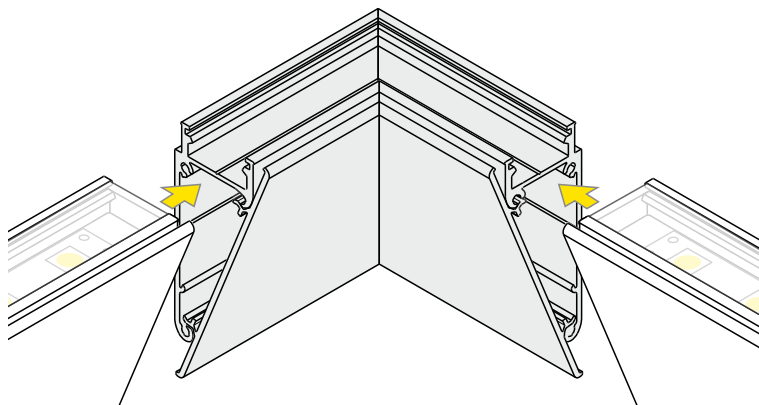

WALLE12 L connector

YSER X connector

IX POWER SUPPLY

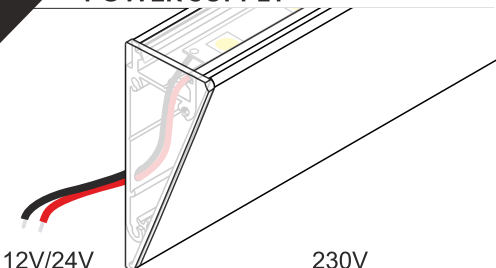

12V/24V

230V

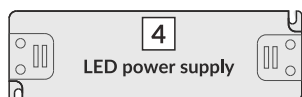

ACCESSORIES

- power switches
- controller + remote
- movement sensors